

RoHS Compliance

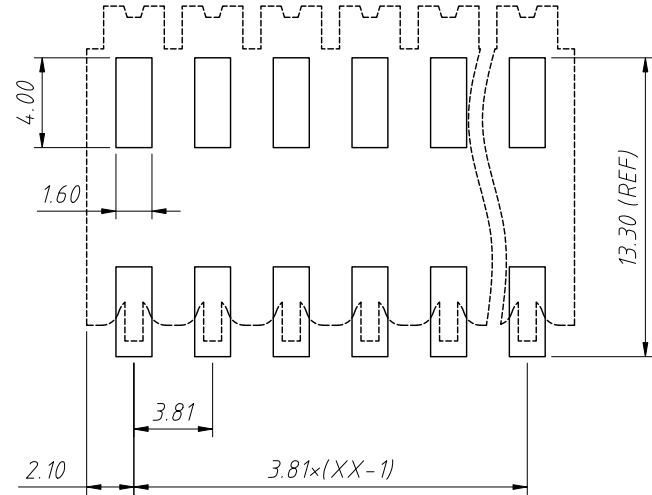

PCB LAYOUT

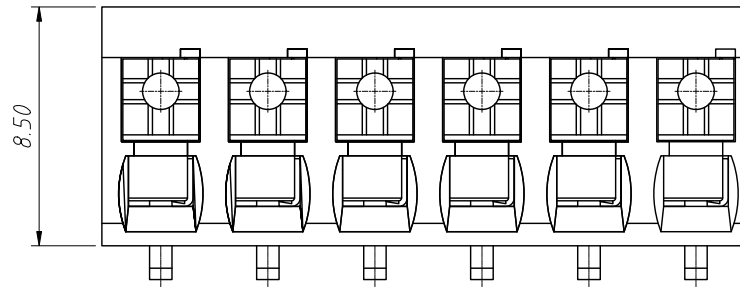
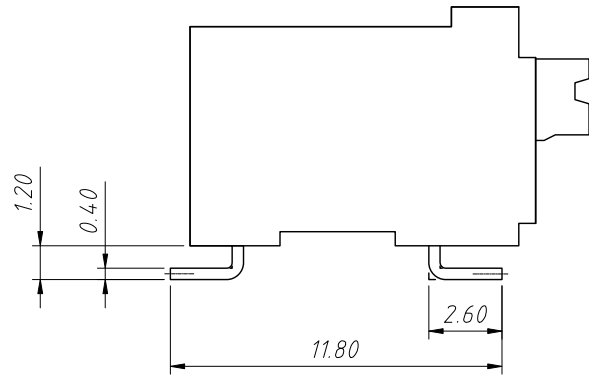
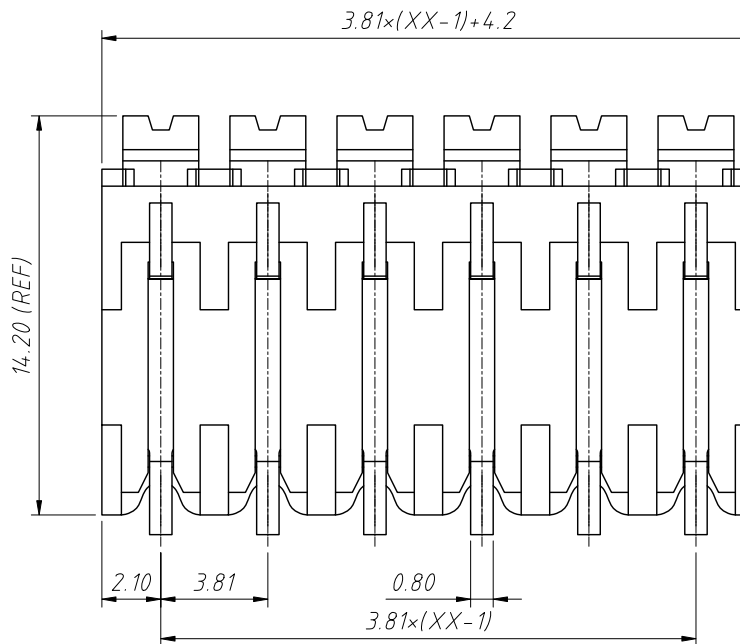

Material:
 Insulation: LCP, UL94V-0
 Contactor: Copper alloy, Sn plated

Electrical:
 Rated Voltage: 300V
 Rated Current: 10A
 Withstanding Voltage: 1600VAC(1min)

Mechanical:
 Wire Range: 16-24AWG
 Stripping Length: 7-8mm
 Pin Dimensions: 0.8x0.4mm
 Operating temperature: -40°C to +130°C

Order Information:
 L-KLS2-212RS-3.81-XXP-X

L: RoHS
 Terminal Block
 Pitch: 3.81mm
 No. of 02 ~ 24 Pole
 Color:
 1=Gray 2=Blue 3=Black
 4=Green 5=Orange 6=Red
 7=Transp 8=Yellow 9=White

ANGLE TOLERANCE	PROJECTION	Description:
±3°		3.81mm PCB Spring Terminal Block
GENERAL TOLERANCE	UNITS	mm
x.x ±0.30	SHEET SIZE	A4
x.xx ±0.20	Draw:	Daniel 2023-05-05
x.xxx ±0.10	Check:	Daniel 2023-05-05
		KLS P/N: L-KLS2-212RS-3.81-XXP-X



NingBo KLS ELECTRONIC CO.,L TD.