

RoHS Compliance

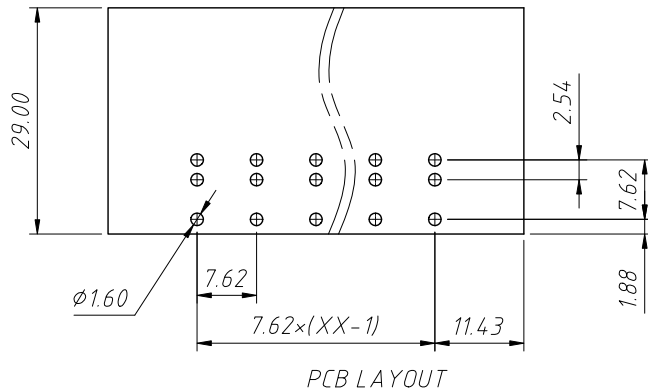
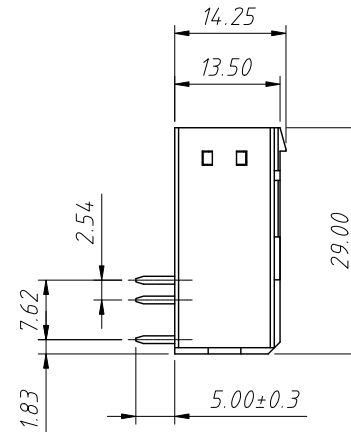
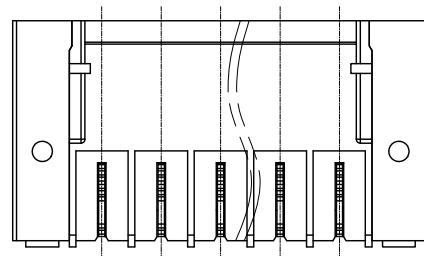
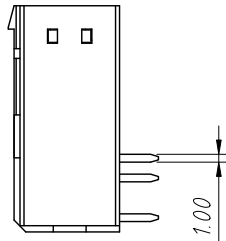
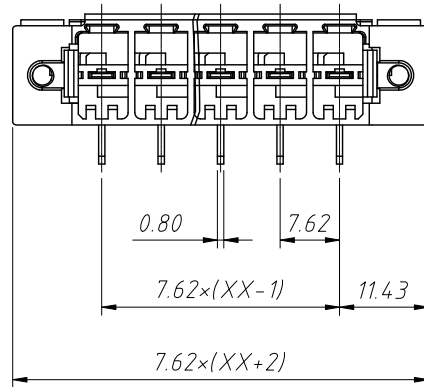

PCB LAYOUT

Material:
Insulation: PA, UL 94 V-0
Contactor: Copper alloy, Sn plated

Electrical:
Rated Voltage: 300V
Rated Current: 41A
Withstanding Voltage: 1600VAC (1min)

Mechanical:
Operating temperature: -40°C to +105°C

Order Information:

L-KLS2-EDRYM-7.62-XXP-X

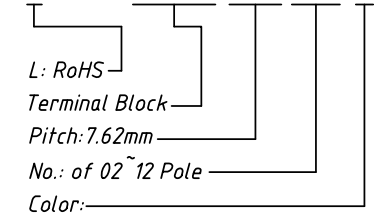

Color:
1=Gray 2=Blue 3=Black
4=Green 5=Orange 6=Red
7=Transp 8=Yellow 9=White

ANGLE TOLERANCE	PROJECTION	Description:	7.62mm Pluggable terminal block	
±3°				
GENERAL TOLERANCE	UNITS	mm	KLS P/N:	L-KLS2-EDRYM-7.62-XXP-X
x.x ±0.30	SHEET SIZE	A4		
x.xx ±0.20	Draw:	Daniel	2023-05-05	NingBo KLS ELECTRONIC CO.,L TD.
x.xxx ±0.10	Check:	Daniel	2023-05-05	