

1
RoHS Compliance

2

3

4

5

6

7

8

A

A

B

B

C

C

D

D

E

E

F

F

G

G

H

H

Pins	N	Pins	N
02	5.08	14	35.56
03	10.16	15	35.56
04	10.16	16	40.64
05	10.16	17	40.64
06	15.24	18	45.72
07	15.24	19	45.72
08	20.32	20	50.80
09	20.32	21	50.80
10	25.40	22	55.88
11	25.40	23	55.88
12	30.48	24	60.96
13	30.48		

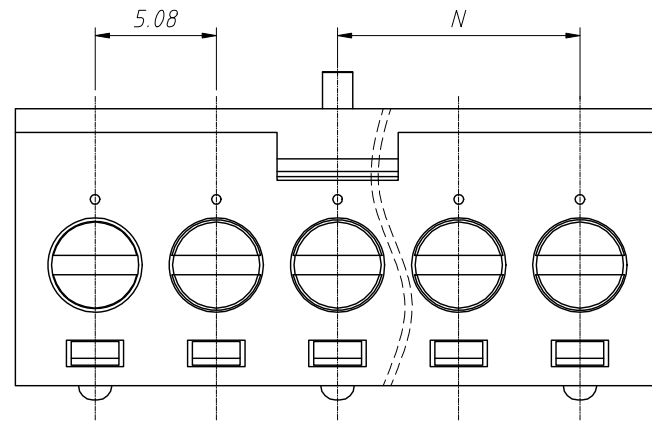

Material:
Insulation:PA66,UL 94 V-0
Contact: Copper alloy, Sn plated

Electrical:
Rated Voltage:300V
Rated Current:18A
Withstanding Voltage:1600VAC(1min)

Mechanical:
Wire Range:12-30AWG
Stripping Length:7-8mm
Screw:M3/Torque:0.5N.m Max
Operating temperature:-40°C to +105°C

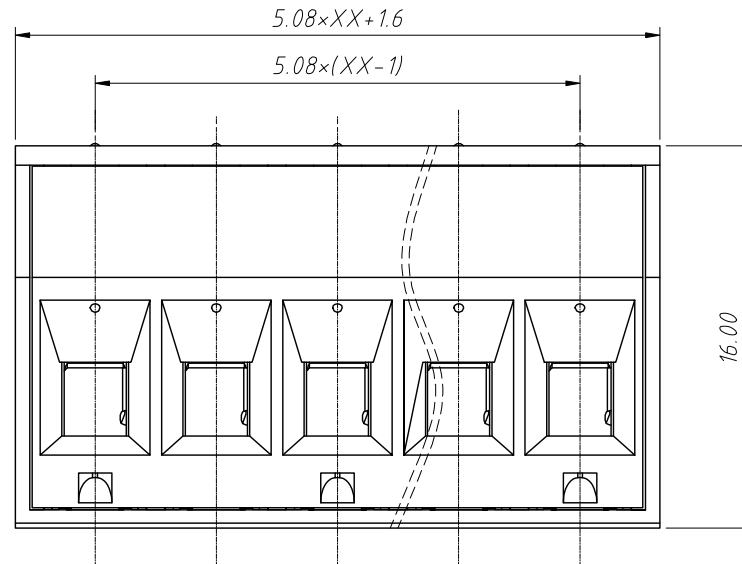

Order Information:
L-KLS2-EDGKJ-5.08-XXP-X

L: RoHS
Terminal Block
Pitch:5.08mm
No.: of 02~24 Pole
Color:
1=Gray 2=Blue 3=Black
4=Green 5=Orange 6=Red
7=Transp 8=Yellow 9=White

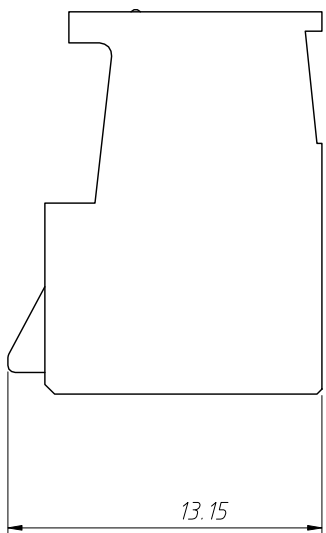

ANGLE TOLERANCE		PROJECTION		Description:	
$\pm 3^\circ$				5.08mm Pluggable terminal block	
GENERAL TOLERANCE		UNITS	mm	KLS P/N:	L-KLS2-EDGKJ-5.08-XXP-X
x.x	± 0.30	SHEET SIZE	A4		
x.xx	± 0.20	Draw:	Daniel	2023-05-05	NingBo KLS ELECTRONIC CO.,LTD.
x.xxx	± 0.10	Check:	Daniel	2023-05-05	