

PCB Layout

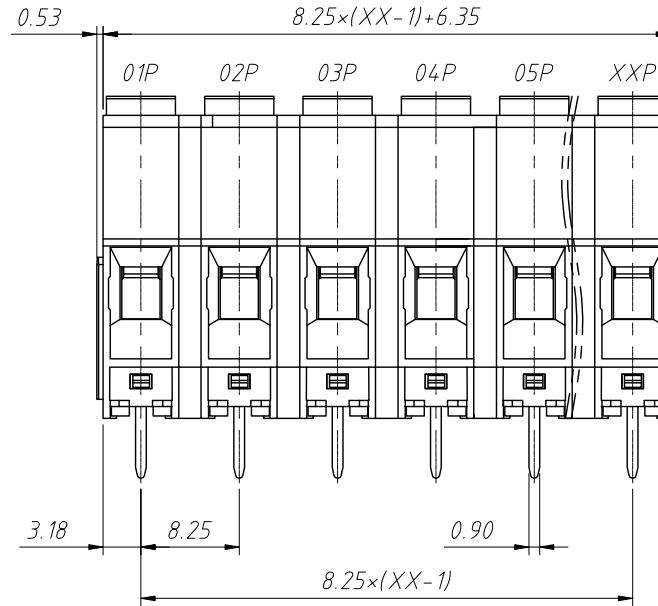
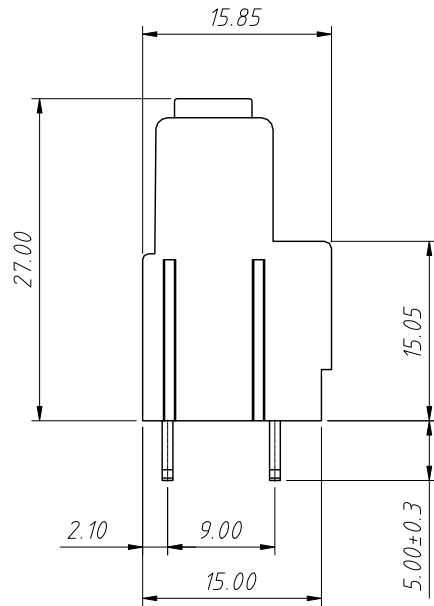
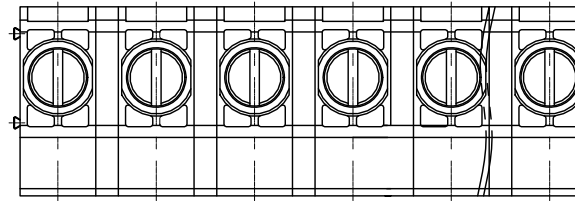

**Material:**  
 Insulation: PA66, UL 94 V-0  
 Contactor: Copper alloy, Sn plated

**Electrical:**  
 Rated Voltage: 600V  
 Rated Current: 30A  
 Withstanding Voltage: 2200VAC (1min)  
 Wire range: 10-24 AWG

**Mechanical:**  
 Stripping Length: 8mm  
 Screw Torque: M3/0.5 (Max) (N.m)  
 Operating temperature: -40°C to +105°C  
 Soldering Temperature: 260°C/5S  
 Pin Dimensions: 0.9×0.9mm  
 PCB Hole Diameter: Ø1.5mm

**Order Information**

L-KLS2-137-8.25-XXP-X-X

RoHS  
 Terminal Block  
 Pitch: 8.25mm  
 No.: of 01 ~ 12 Pole  
 Color: 1=Gray 2=Blue 3=Black  
 4=Green 5=Orange 6=Red  
 7=Transp. 8=Yellow 9=White  
 Screw: S-Slot Screw C-Cross Screw

GENERAL TOLERANCE		ANGLE TOLERANCE		Description:	
X. ±0.60		X. ±5°		8.25mm Pitch PCB Screw Terminal Block	
.X ±0.38		.X ±3°		KLS P/N:	L-KLS2-137-8.25-XXP-X-X
.XX ±0.25		.XX ±2°			
Draw by	2023-03-16	PROJECTION		NingBo KLS ELECTRONIC CO.,L TD.	
Check by	2023-03-16	UNITS	mm		
SCALE		SHEET SIZE	A4		