

1
RoHS Compliance

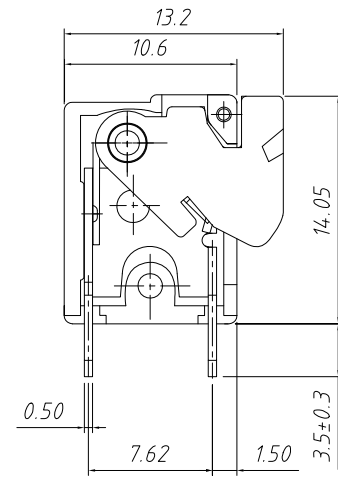
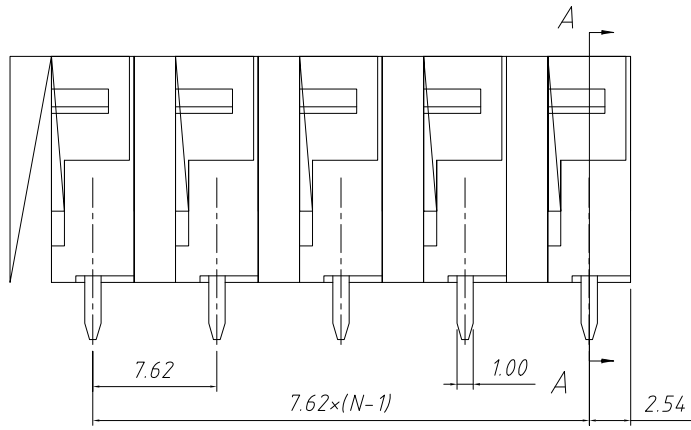

Material
 Shrapnel: Stainless steel
 Pin header: Brass, Tin plated
 Housing: PA66, UL94V-0

Electrical
 Rated voltage: 300V
 Rated current: 10A
 Wire range: 22~16AWG 1.5mm²
 Contact Resistance: 20 mΩ
 Insulation resistance: 500MΩ/DC500V
 Withstand voltage: AC2000V / 1 min

SECTION A-A

Mechanical
 Temp. Range: -40 °C ~ +105 °C
 Soldering: 250° C ±5° C for 5S
 Strip length: 9~10 mm

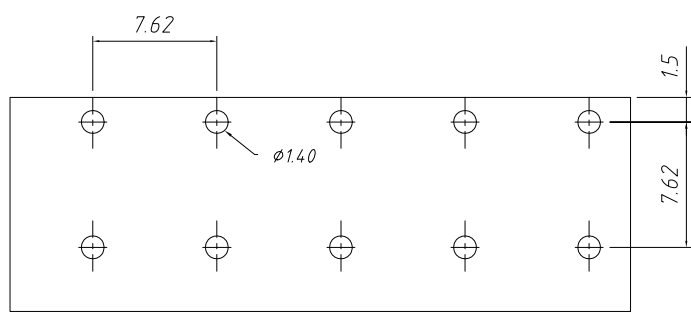
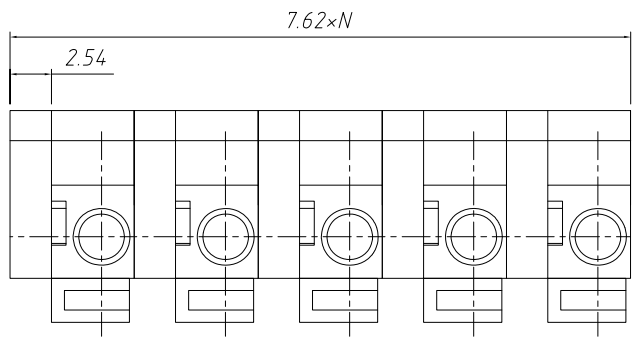

PCB LAYOUT

Order Information

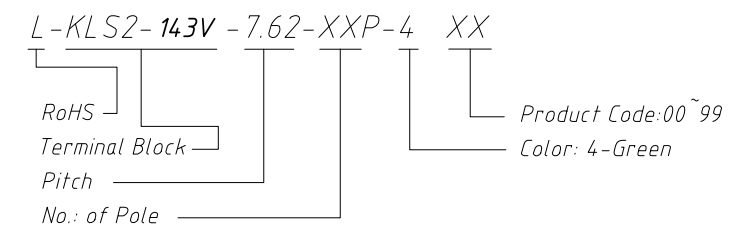

ANGLE TOLERANCE	PROJECTION	Description:	
±3°		7.62mm Spring Clamp Terminal Block	
GENERAL TOLERANCE	UNITS	mm	KLS P/N:
x.x ±0.30	SHEET SIZE	A4	L-KLS2-143V-7.62-XXP-4
x.xx ±0.20	Draw:	Daniel	2023-06-01
x.xxx ±0.10	Check:	Daniel	2023-06-01

