

1 RoHS Compliance

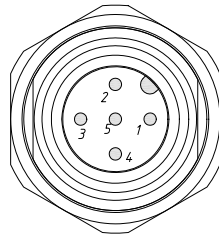

Front view

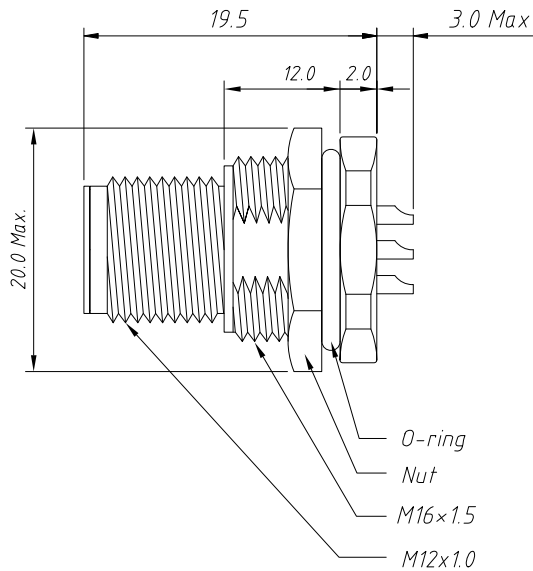
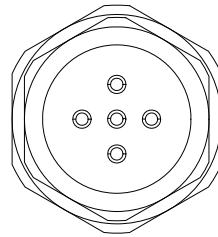

Back view

Electrical & Mechanical data

IP rating:IP67

Contacts resistance:≤ 5 mΩ

Insulation resistance:≥100 MΩ

Orientation: Soldering, Front Lock

Over mold/ Shell: Metal shell

Connector contacts: Brass with gold plated

Coupling nut/screw: Brass with nickel plated screw

Insert/ Housing: PA66 + GF

Sealing: O-ring

Temperature Range: -25°C ~ + 80°C

	4 Pin	5 Pin	8 Pin
Rated current	4A	4A	2A
Rated voltage	250V	60V	30V

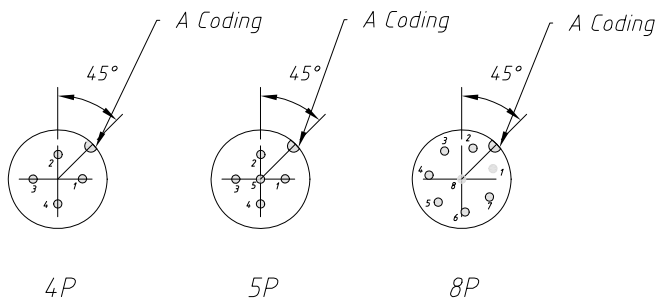

Order Information:

L-KLS15-M12 A-L2 XX

L: RoHS

M12: Screw type

A:A Coding B:B Coding

C:C Coding D:D Coding

L2:Soldering, Panel mount,

Front lock, Male

XX: Number of Contacts

ANGLE TOLERANCE	PROJECTION	Description:
±3°		Soldering connector, Panel mount, Front lock, Automation technology, M12, Male
GENERAL TOLERANCE	UNITS	mm
x.x ±0.30	SHEET SIZE	A4
x.xx ±0.20	Draw:	Daniel 2023-05-15
x.xxx ±0.10	Check:	Daniel 2023-05-15



NingBo KLS ELECTRONIC CO.,L TD.