

1 RoHS Compliance

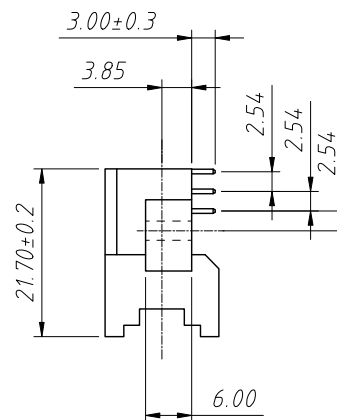

Note:
Material:
Housing:PBT+30%G.F Ul94 v-0 Color:Beige
Contacts:Brass,2u"Gold Plated

Electrical
Current Rating:5.6 A
Contact Resistance:20 M Ω Initial
Insulation Resistance:1000 M Ω Min @ 500 VDC
Dielectric Withstanding Voltage:1000 VAC / Minute
Operating Temperature:-55°C To +125°C

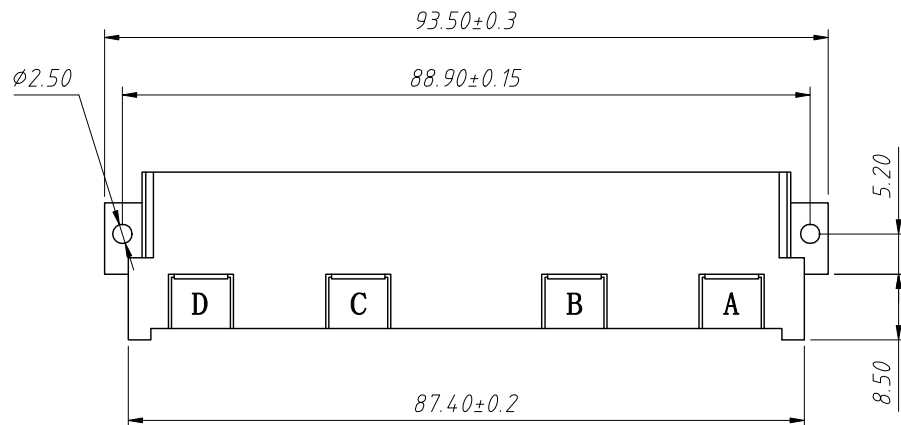
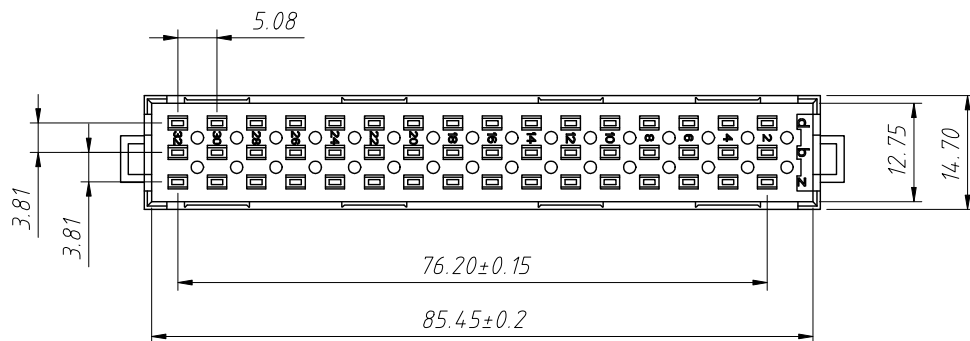

Order Information

L-KLS1-F48-3348-M R

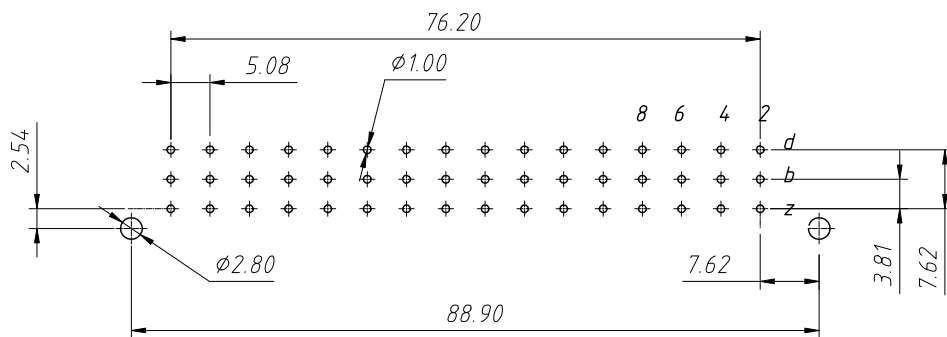
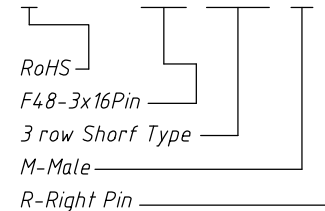

Recommended PCB Layout
Tolerance: ± 0.05 mm

ANGLE TOLERANCE	PROJECTION	Description:		
$\pm 3^\circ$		DIN4 1612 Connector With F Type		
GENERAL TOLERANCE	UNITS	mm	KLS P/N:	L-KLS1-F48-3348-MR
x.x ± 0.30	SHEET SIZE	A4	XX	NingBo KLS ELECTRONIC CO.,L TD.
x.xx ± 0.20	Draw:	Daniel	2023-04-25	
x.xxx ± 0.10	Check:	Daniel	2023-04-25	