

AV-F7025



SIZE:

70x70x25mm

construction:

Glass Fiber reinforced plastic;
Impeller and housing PBT

OPERATING TEMPERATURE:

Sleeve bearing -10°C to +70°C

INSULATION RESISTANCE:

10meg Ohm min, at 500 VDC
(between frame and terminal)

DIELECTRIC STRENGTH:

5mA max, at 500 VAC 60Hz one minute
(between frame and terminal)

Dimensions Drawing

Unit:mm

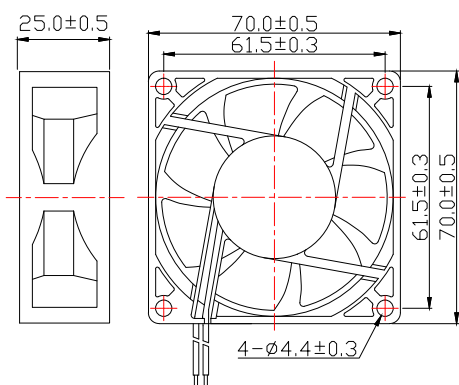

Characteristic Curves

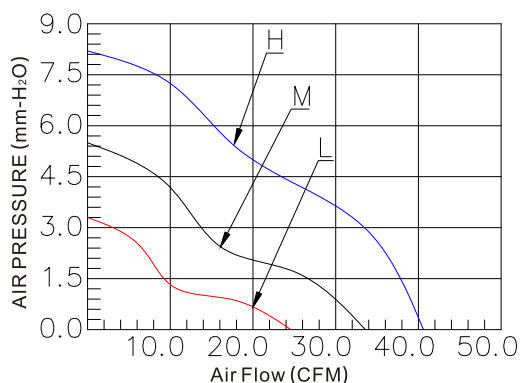

Specifications

Carton Specifications (Unit: cm):37x26x30 QTY:200pcs GW:12.64Kg

Model	Bearing Type	Rated Voltage	Operation Voltage	Current	Speed	Air Flow	Static Pressure	Noise Level	Weight
		VDC	VDC	A	RPM	CFM	mmH ₂ O	dBA	g
AV-F7025HS	Sleeve	12	10.8~13.2	0.30	4000	40.32	7.71	36.86	59.3
AV-F7025MS	Sleeve	12	10.8~13.2	0.20	3400	31.53	4.95	29.49	59.3
AV-F7025LS	Sleeve	12	10.8~13.2	0.15	3000	23.72	3.10	24.84	59.3
AV-F7025HB	Ball	12	10.8~13.2	0.30	4000	40.32	7.71	36.86	59.3
AV-F7025MB	Ball	12	10.8~13.2	0.20	3400	31.53	4.95	29.49	59.3
AV-F7025LB	Ball	12	10.8~13.2	0.15	3000	23.72	3.10	24.84	59.3
AV-F7025HS24	Sleeve	24	21.6~26.4	0.20	4000	40.32	7.71	36.86	59.3
AV-F7025MS24	Sleeve	24	21.6~26.4	0.11	3400	31.53	4.95	29.49	59.3
AV-F7025LS24	Sleeve	24	21.6~26.4	0.08	3000	23.72	3.10	24.84	59.3
AV-F7025HB24	Ball	24	21.6~26.4	0.20	4000	40.32	7.71	36.86	59.3
AV-F7025MB24	Ball	24	21.6~26.4	0.11	3400	31.53	4.95	29.49	59.3
AV-F7025LB24	Ball	24	21.6~26.4	0.08	3000	23.72	3.10	24.84	59.3