

1 RoHS Compliance

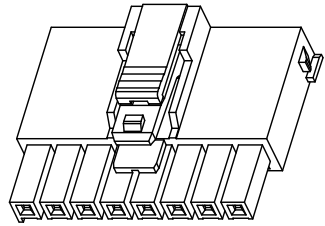

TPA Type, A KEY

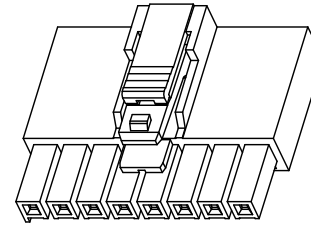
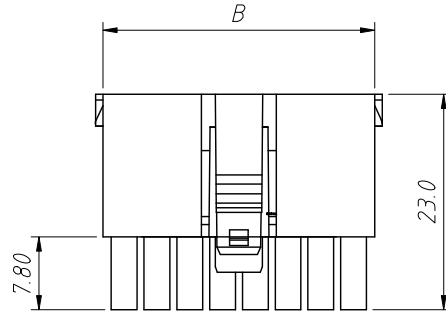

Standard, A KEY

Material:
Housing:PA66,UL94V-0

Electrical Characteristics:
Voltage rating:400V AC,DC
Current rating:14A AC,DC
Withstanding voltage:1800V AC minute
Insulation resistance:1000M Ω Min.
Contact resistance:10m Ω Max.
After environmental testing:30m Ω Max.
Temperature range:-40 $^{\circ}$ C ~ +105 $^{\circ}$ C

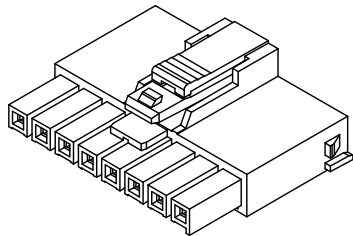
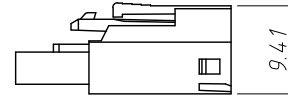
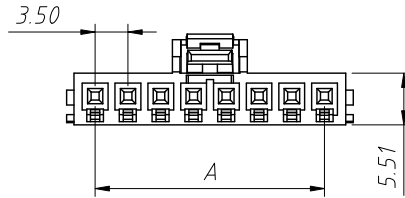
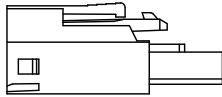

TPA Type, B KEY

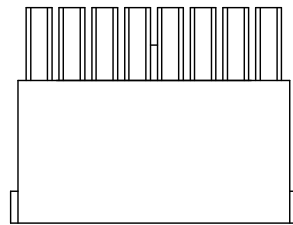

Pin	Dimensions (mm)	
	A	B
02	3.50	8.00
03	7.00	11.50
04	10.50	15.00
05	14.00	18.50
06	17.50	22.00
07	21.00	25.50
08	24.50	29.00
12	38.50	43.00

Order Information:

L-KLS1-XL2-3.50-1 \times XX-H-B

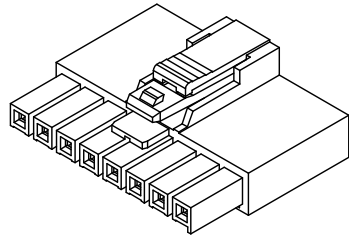
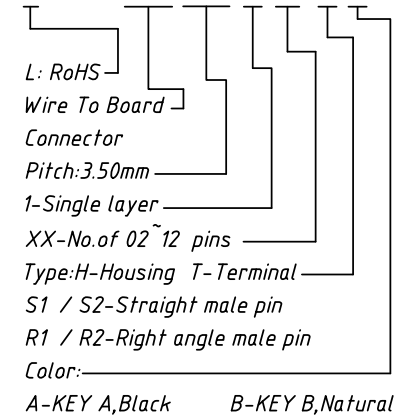

Standard, B KEY

ANGLE TOLERANCE	PROJECTION	Description:
$\pm 3^{\circ}$		3.50mm Pitch Ultra-Fit 172256 172258 Wire To Board Connector
GENERAL TOLERANCE	UNITS	mm
x.x ± 0.30	SHEET SIZE	A4
x.xx ± 0.20	Draw:	Daniel 2020-11-11
x.xxx ± 0.10	Check:	Daniel 2020-11-11

L-KLS1-XL2-3.50-1 \times XX-H-B

NingBo KLS ELECTRONIC CO.,L TD.

1 RoHS Compliance

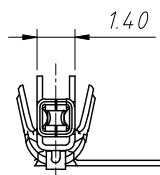
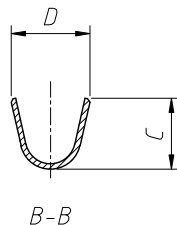
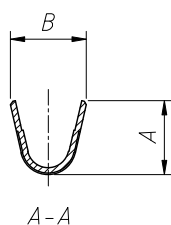
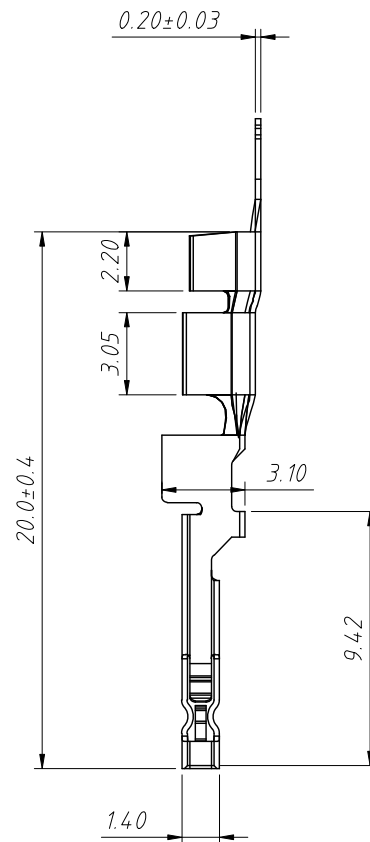
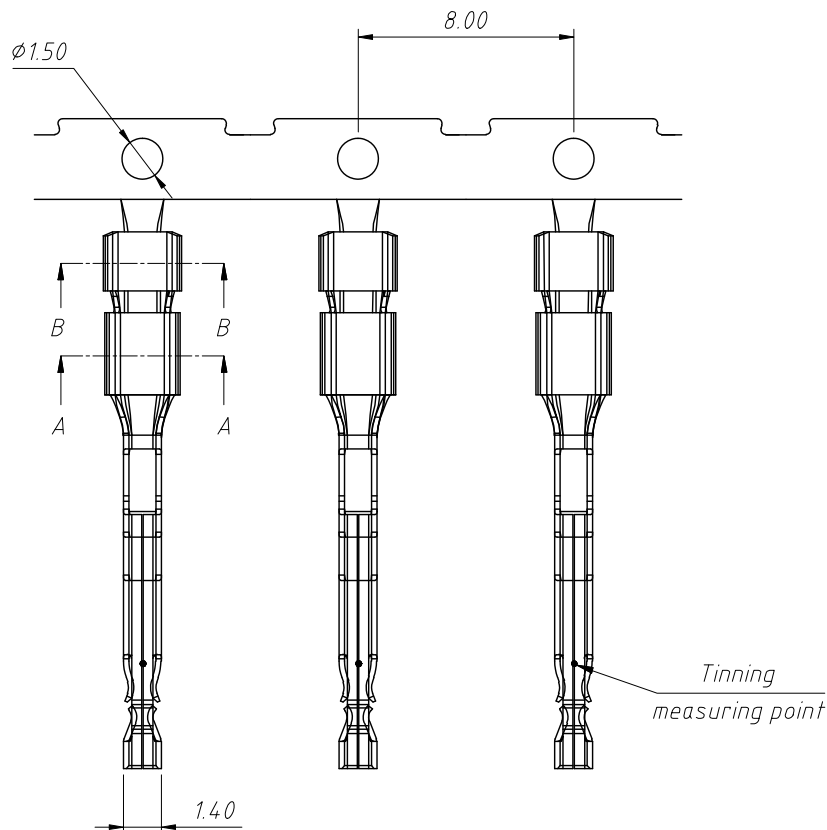

Material:
Terminal: High Conductivity Copper
Plating style: Contact Gold Flash or
All Gold plating
Applicable Wire Range: AWG#16 ~ #22

Electrical Characteristics:
Voltage rating: 400V AC, DC
Current rating: 14A AC, DC
Withstanding voltage: 1800V AC minute
Insulation resistance: 1000MΩ Min.
Contact resistance: 10mΩ Max.
After environmental testing: 30mΩ Max.
Temperature range: -40°C ~ +105°C

Order Information:

L-KLS1-XL2-3.50-T-X-X

L: RoHS
Wire To Board
Connector
Pitch: 3.50mm
Type: T - Terminal
Plating style:
B - Contact Gold Flash or
Q - All Gold plating
Mold No.:
G - High Lever D - Low Lever

Ordering Information

Part No.	Wire range	A	B	C	D
3.50-T-X-D	#20-#22	2.20	2.20	2.10	2.33
3.50-T-X-G	#16-#18	2.80	2.80	2.63	2.90

ANGLE TOLERANCE	PROJECTION	Description:
±3°		3.50mm Pitch Ultra-Fit 172256 172258 Wire To Board Connector
GENERAL TOLERANCE	UNITS	mm
x.x ±0.30	SHEET SIZE	A4
x.xx ±0.20	Draw:	Daniel 2020-11-11
x.xxx ±0.10	Check:	Daniel 2020-11-11



NingBo KLS ELECTRONIC CO., L.TD.

1 RoHS Compliance

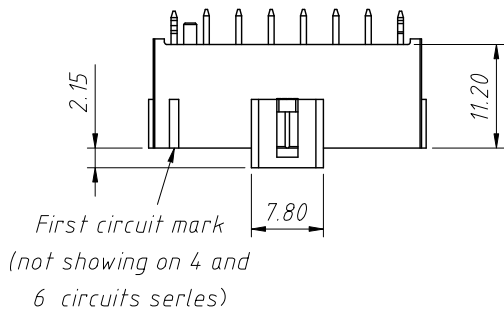

Pin	Dimensions(mm)	
	A	B
02	3.50	8.00
03	7.00	11.50
04	10.50	15.00
05	14.00	18.50
06	17.50	22.00
07	21.00	25.50
08	24.50	29.00
12	38.50	43.00

Material:
Housing:LCP,UL 94V-0
Contact:Copper Alloy With Tin;
Au or Brass

Electrical Characteristics:
Voltage rating:400V AC,DC
Current rating:14A AC,DC
Withstanding voltage:1800V AC minute
Insulation resistance:1000M Ω Min.
Contact resistance:10m Ω Max.
After environmental testing:30m Ω Max.
Temperature range:-40 $^{\circ}$ C ~ +105 $^{\circ}$ C

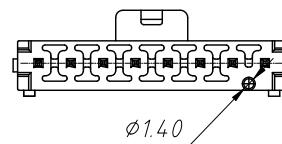
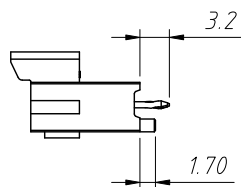
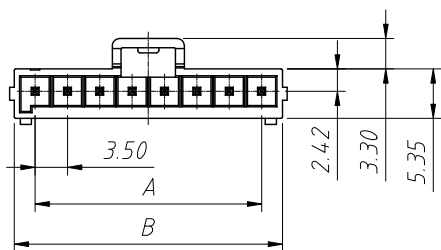

Order Information:

L-KLS1-XL2-3.50-1 \times XX-S1-B

L: RoHS
Wire To Board
Connector
Pitch:3.50mm
1-Single layer
XX-No. of 02~12 pins
Type:H-Housing T-Terminal
S1 / S2-Straight male pin
R1 / R2-Right angle male pin
Color:
A-KEY A,Black B-KEY B,Natural

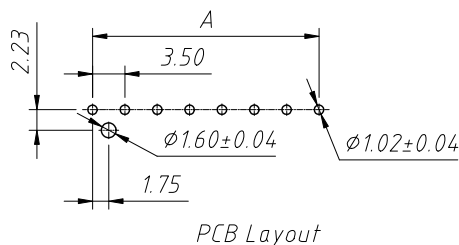
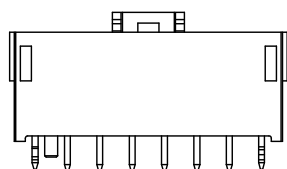

PCB Layout

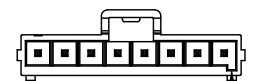

B KEY

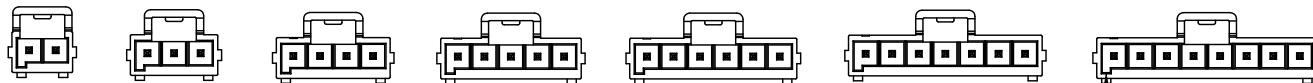

A KEY

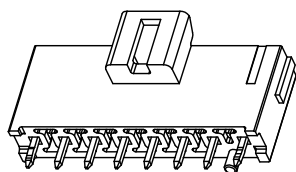

ANGLE TOLERANCE	PROJECTION	Description:	3.50mm Pitch Ultra-Fit 172256
$\pm 3^{\circ}$			172258 Wire To Board Connector
GENERAL TOLERANCE	UNITS	mm	KLS P/N:
x.x ± 0.30	SHEET SIZE	A4	L-KLS1-XL2-3.50-1 \times XX-S1-B
x.xx ± 0.20	Draw:	Daniel	2020-11-11
x.xxx ± 0.10	Check:	Daniel	2020-11-11



NingBo KLS ELECTRONIC CO.,L TD.

1 RoHS Compliance

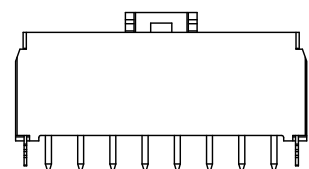
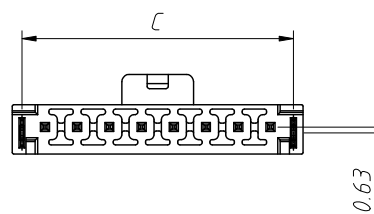
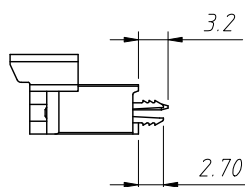
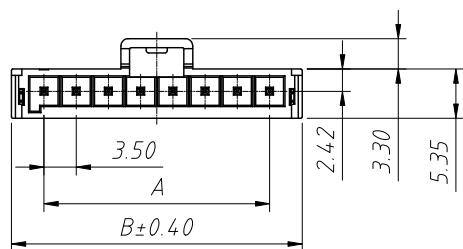
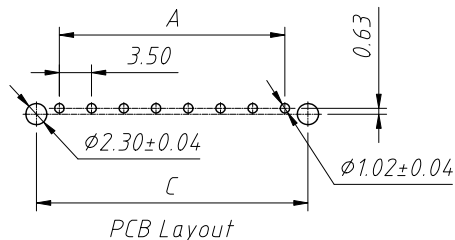
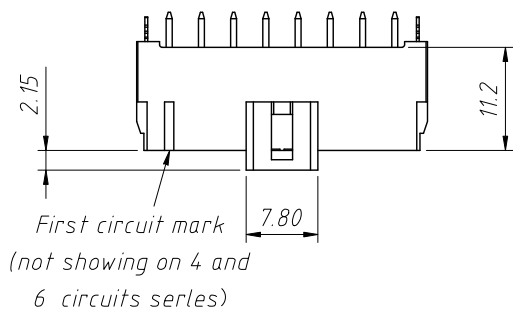

Pin	Dimensions(mm)		
	A	B	C
02	3.50	10.60	8.50
03	7.00	14.10	12.00
04	10.50	17.60	15.50
05	14.00	21.10	19.00
07	21.00	28.10	16.00
08	24.50	31.60	29.50
12	38.50	45.60	43.50

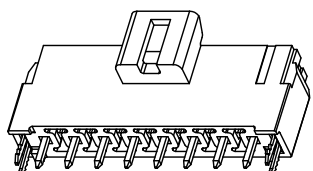
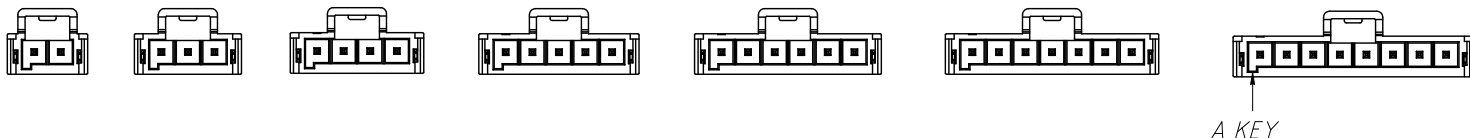

Material:
Housing:LCP,UL 94 V-0
Contact:Copper Alloy With Tin/Au

Electrical Characteristics:
Voltage rating:400V AC,DC
Current rating:14A AC,DC
Withstanding voltage:1800V AC minute
Insulation resistance:1000M Ω Min.
Contact resistance:10m Ω Max.
After environmental testing:30m Ω Max.
Temperature range:-40°C ~ +105°C

Order Information:
L-KLS1-XL2-3.50-1×XX-S2-B

L: RoHS
Wire To Board
Connector
Pitch:3.50mm
1-Single layer
XX-No. of 02 ~ 12 pins
Type:H-Housing T-Terminal
S1 / S2-Straight male pin
R1 / R2-Right angle male pin
Color:
A-KEY A,Black B-KEY B,Natural

ANGLE TOLERANCE	PROJECTION	Description:
$\pm 3^\circ$		3.50mm Pitch Ultra-Fit 172256 172258 Wire To Board Connector
GENERAL TOLERANCE	UNITS	mm
x.x ± 0.30	SHEET SIZE	A4
x.xx ± 0.20	Draw:	Daniel 2020-11-11
x.xxx ± 0.10	Check:	Daniel 2020-11-11

KLS NingBo KLS ELECTRONIC CO.,L TD.

1 RoHS Compliance

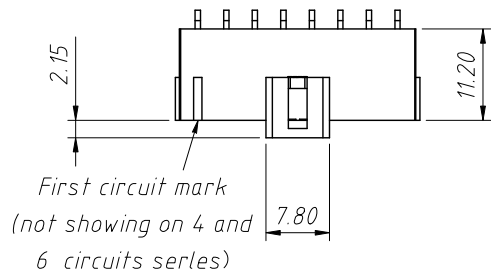

Pin	Dimensions(mm)		
	A	B	C
02	3.50	8.00	---
03	7.00	11.50	---
04	10.50	15.00	7.00
05	14.00	18.50	10.50
06	17.50	22.00	14.00
07	21.00	25.50	17.50
08	24.50	29.00	21.00
12	38.50	43.00	34.00

Material:
Housing:LCP,UL94V-0
Contact:Copper Alloy With Tin/Au

Electrical Characteristics:
Voltage rating:400V AC,DC
Current rating:14A AC,DC
Withstanding voltage:1800V AC minute
Insulation resistance:1000M Ω Min.
Contact resistance:10m Ω Max.
After environmental testing:30m Ω Max.
Temperature range:-40°C ~ +105°C

Order Information:
L-KLS1-XL2-3.50-1 \times XX-R1-B

L: RoHS
Wire To Board
Connector
Pitch:3.50mm
1-Single layer
XX-No. of 02~12 pins
Type:H-Housing T-Terminal
S1 / S2-Straight male pin
R1 / R2-Right angle male pin
Color:
A-KEY A,Black B-KEY B,Natural

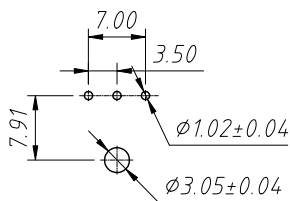
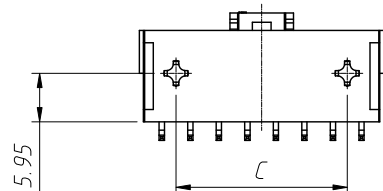
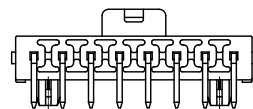
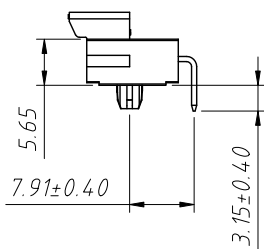
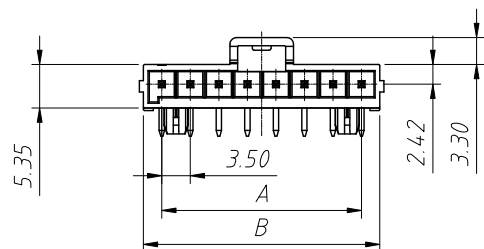

PCB Layout
(2-3 Pin)

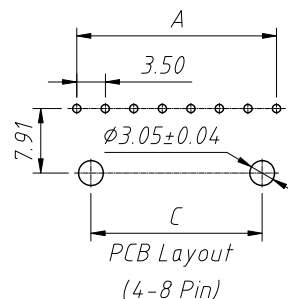

PCB Layout
(4-8 Pin)

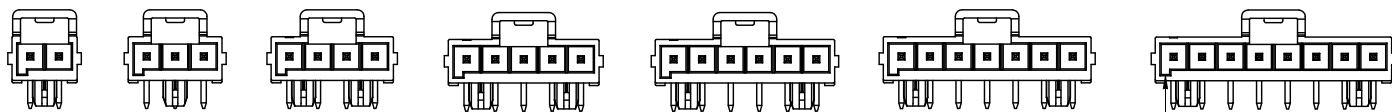

A KEY

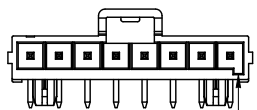
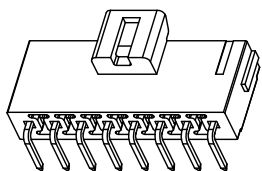

B KEY

ANGLE TOLERANCE	PROJECTION	Description:	3.50mm Pitch Ultra-Fit 172256
$\pm 3^\circ$			172258 Wire To Board Connector
GENERAL TOLERANCE	UNITS	mm	KLS P/N:
x.x ± 0.30	SHEET SIZE	A4	L-KLS1-XL2-3.50-1 \times XX-R1-B
x.xx ± 0.20	Draw:	Daniel	2020-11-11
x.xxx ± 0.10	Check:	Daniel	2020-11-11



NingBo KLS ELECTRONIC CO.,LTD.

1 RoHS Compliance

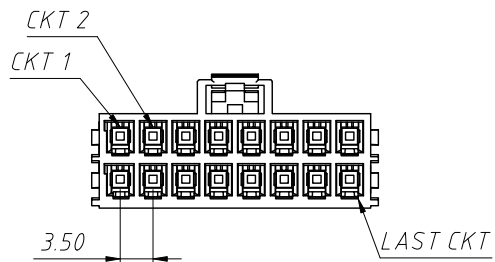
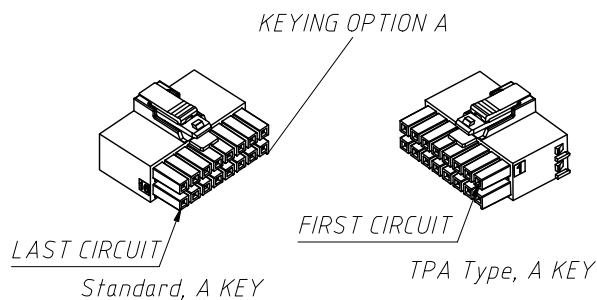

Material:
Housing:PA66,UL94V-0

Electrical Characteristics:
Voltage rating:400V AC,DC
Current rating:14A AC,DC
Withstanding voltage:1800V AC minute
Insulation resistance:1000M Ω Min.
Contact resistance:10m Ω Max.
After environmental testing:30m Ω Max.
Temperature range:-40°C ~ +105°C

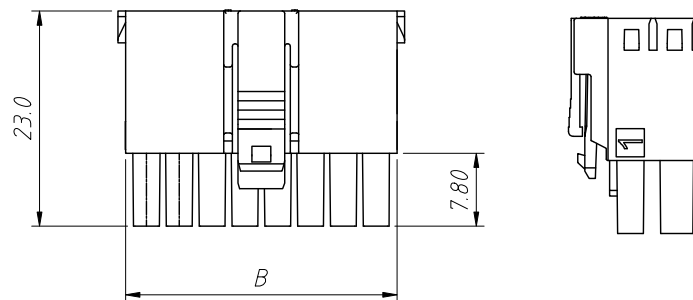
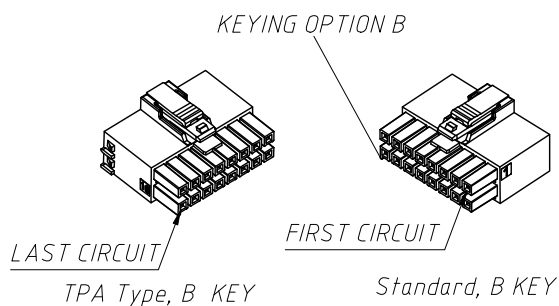

Order Information:
L-KLS1-XL2-3.50-2 \times XX-H-B

L: RoHS
Wire To Board
Connector
Pitch:3.50mm
2-Double layer
XX-No. of 04 ~ 24 pins
Type:H-Housing T-Terminal
S1 / S2-Straight male pin
R1 / R2-Right angle male pin
Color:
A-KEY A,Black B-KEY B,Natural

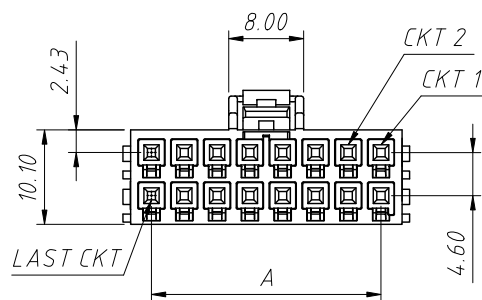
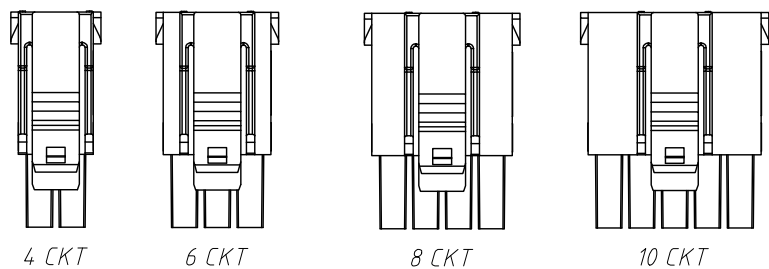

Pin	Dimensions(mm)	
	A	B
2 \times 02	3.50	8.00
2 \times 03	7.00	11.50
2 \times 04	10.50	15.00
2 \times 05	14.00	18.50
2 \times 06	17.50	22.00
2 \times 07	21.00	25.50
2 \times 08	24.50	29.00
2 \times 12	38.50	43.00

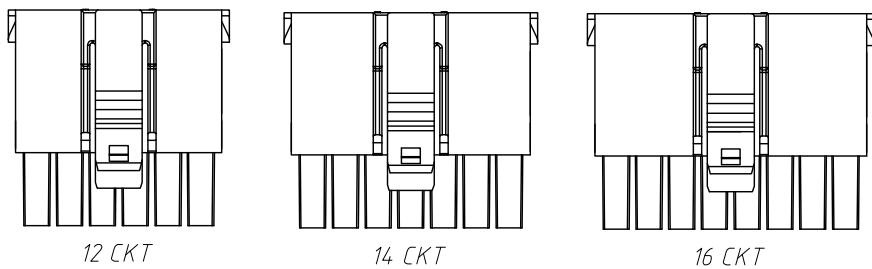

ANGLE TOLERANCE	PROJECTION	Description:	3.50mm Pitch Ultra-Fit 172256
$\pm 3^\circ$			172258 Wire To Board Connector
GENERAL TOLERANCE	UNITS	mm	KLS P/N: L-KLS1-XL2-3.50-2 \times XX-H-B
x.x ± 0.30	SHEET SIZE	A4	NingBo KLS ELECTRONIC CO.,L TD.
x.xx ± 0.20	Draw:	Daniel 2020-11-11	
x.xxx ± 0.10	Check:	Daniel 2020-11-11	

1
RoHS Compliance

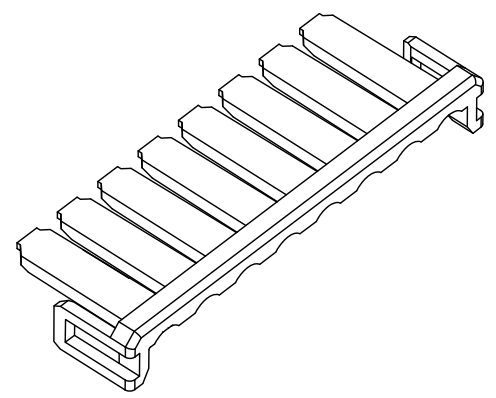
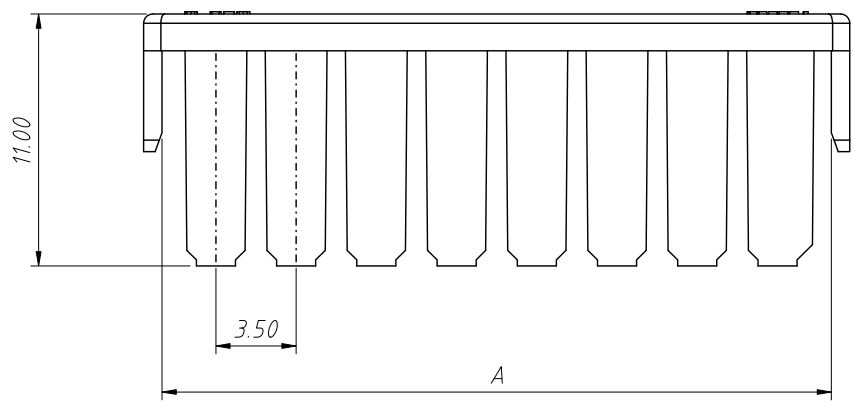

Material:
Housing:PA66,UL 94 V-0

Electrical Characteristics:
Voltage rating:400V AC,DC
Current rating:14A AC,DC
Withstanding voltage:1800V AC minute
Insulation resistance:1000M Ω Min.
Contact resistance:10m Ω Max.
After environmental testing:30m Ω Max.
Temperature range:-40 $^{\circ}$ C ~ +105 $^{\circ}$ C

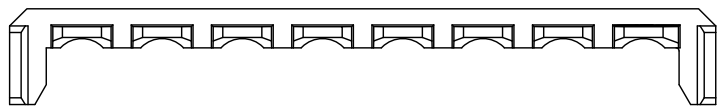

Order Information:

L-KLS1-XL2-3.50-S-XX-B

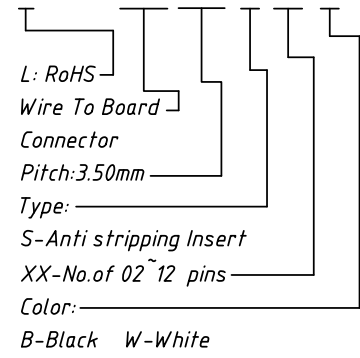

Pin	Dimensions(mm)
	A
02	8.20
03	11.70
04	15.20
05	18.70
06	22.20
07	25.70
08	29.20
12	43.20

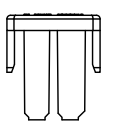

02 P

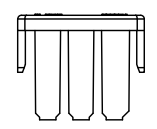

03 P

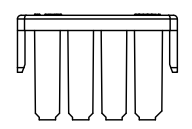

04 P

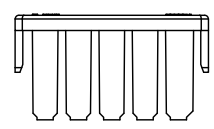

05 P

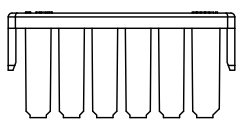

06 P

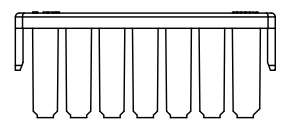

07 P

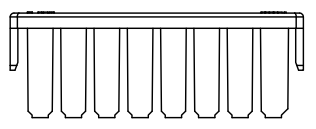

08 P

ANGLE TOLERANCE	PROJECTION	Description:	3.50mm Pitch Ultra-Fit 172256 172258 Wire To Board Connector
$\pm 3^{\circ}$			
GENERAL TOLERANCE	UNITS	mm	KLS P/N: L-KLS1-XL2-3.50-S-XX-B
x.x ± 0.30	SHEET SIZE	A4	
x.xx ± 0.20	Draw:	Daniel	2020-11-11
x.xxx ± 0.10	Check:	Daniel	2020-11-11



NingBo KLS ELECTRONIC CO.,L TD.

1 RoHS Compliance

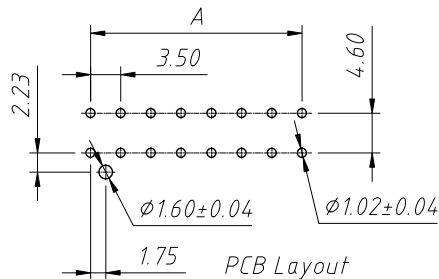
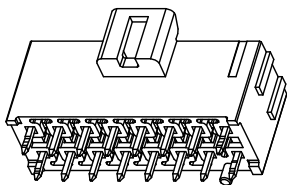
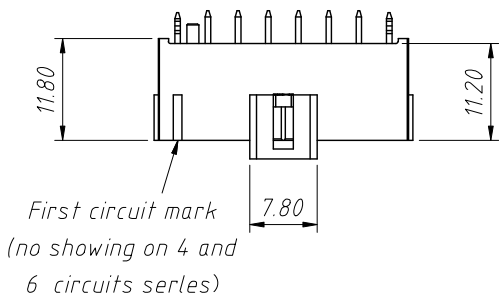

Material:
Housing:LCP,UL94V-0
Contact:Copper Alloy With Tin;
Au or Brass

Electrical Characteristics:
Voltage rating:400V AC,DC
Current rating:14A AC,DC
Withstanding voltage:1800V AC minute
Insulation resistance:1000M Ω Min.
Contact resistance:10m Ω Max.
After environmental testing:30m Ω Max.
Temperature range:-40 $^{\circ}$ C ~ +105 $^{\circ}$ C

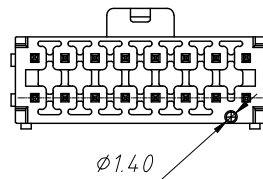
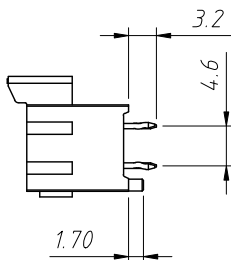
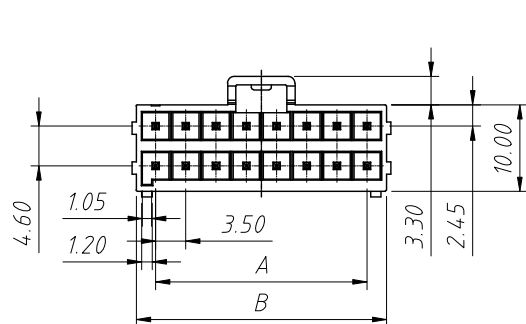

Order Information:

L-KLS1-XL2-3.50-2 \times XX-S1-B

L: RoHS
Wire To Board
Connector
Pitch:3.50mm
2-Double layer
XX-No.of 04 ~ 24 pins
Type:H-Housing T-Terminal
S1 / S2-Straight male pin
R1 / R2-Right angle male pin
Color:
A-KEY A,Black B-KEY B,Natural

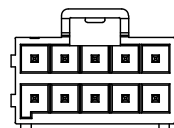
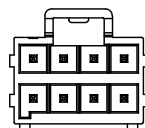
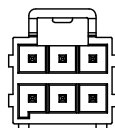
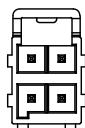
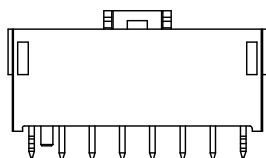

Pin	Dimensions(mm)	
	A	B
2 \times 02	3.50	8.00
2 \times 03	7.00	11.50
2 \times 04	10.50	15.00
2 \times 05	14.00	18.50
2 \times 06	17.50	22.00
2 \times 07	21.00	25.50
2 \times 08	24.50	29.00
2 \times 12	38.50	43.00

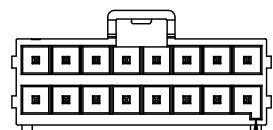
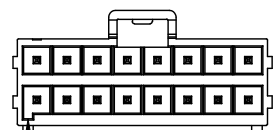
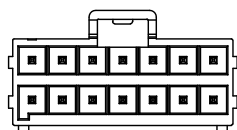
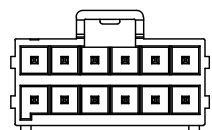

A KEY

B KEY

ANGLE TOLERANCE	PROJECTION	Description:	3.50mm Pitch Ultra-Fit 172256 172258 Wire To Board Connector
$\pm 3^{\circ}$			
GENERAL TOLERANCE	UNITS	mm	KLS P/N:
x.x ± 0.30	SHEET SIZE	A4	L-KLS1-XL2-3.50-2 \times XX-S1-B
x.xx ± 0.20	Draw:	Daniel	2020-11-11
x.xxx ± 0.10	Check:	Daniel	2020-11-11



NingBo KLS ELECTRONIC CO.,L TD.

1 RoHS Compliance

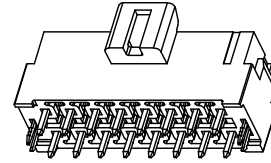
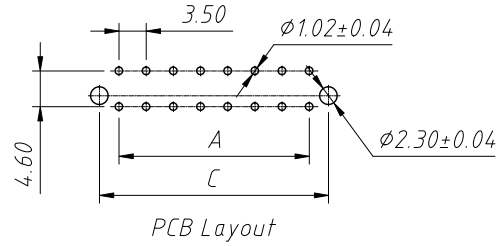
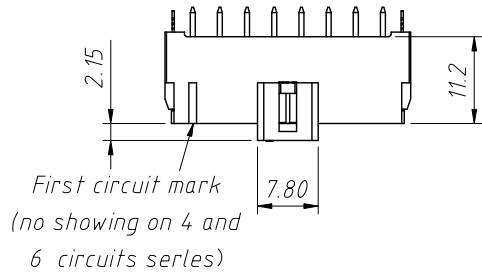

Material:
Housing:LCP,UL 94V-0
Contact:Copper Alloy With Tin/Au

Electrical Characteristics:
Voltage rating:400V AC,DC
Current rating:14A AC,DC
Withstanding voltage:1800V AC minute
Insulation resistance:1000M Ω Min.
Contact resistance:10m Ω Max.
After environmental testing:30m Ω Max.
Temperature range:-40 $^{\circ}$ C ~ +105 $^{\circ}$ C

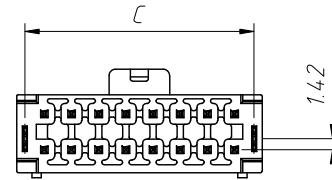
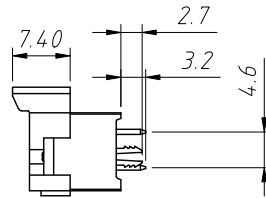
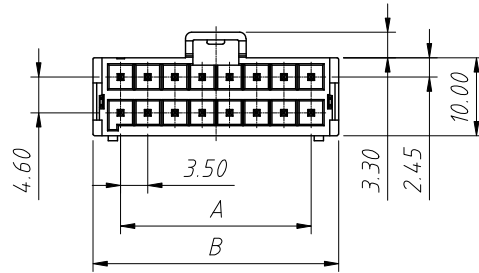

Order Information:

L-KLS1-XL2-3.50-2 \times XX-S2-B

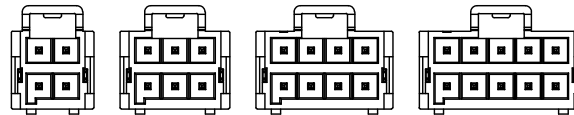
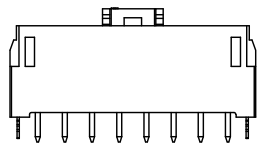
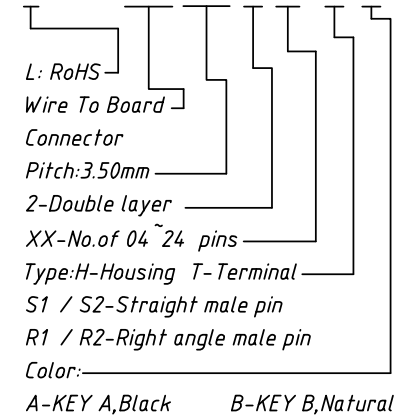

Pin	Dimensions(mm)		
	A	B	C
2 \times 02	3.50	10.60	8.50
2 \times 03	7.00	14.10	12.00
2 \times 04	10.50	17.60	15.50
2 \times 05	14.00	21.10	19.00
2 \times 06	17.50	24.60	22.50
2 \times 07	21.00	28.10	16.00
2 \times 08	24.50	31.60	29.50
2 \times 12	38.50	45.60	43.50

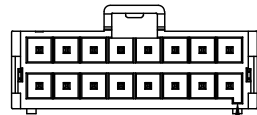

B KEY

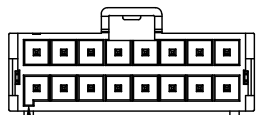
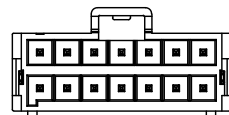
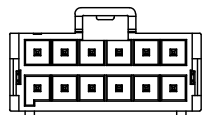

A KEY

ANGLE TOLERANCE	PROJECTION	Description:
$\pm 3^{\circ}$		3.50mm Pitch Ultra-Fit 172256 172258 Wire To Board Connector
GENERAL TOLERANCE	UNITS	mm
x.x ± 0.30	SHEET SIZE	A4
x.xx ± 0.20	Draw:	Daniel 2020-11-11
x.xxx ± 0.10	Check:	Daniel 2020-11-11



NingBo KLS ELECTRONIC CO.,L TD.

1 RoHS Compliance

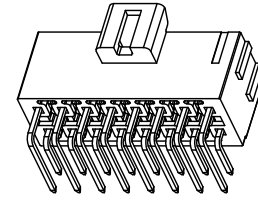
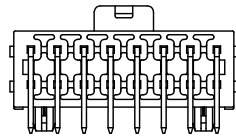
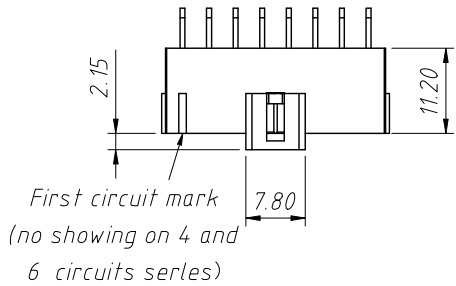

Material:
Housing:LCP,UL94V-0
Contact:Copper Alloy With Tin/Au

Electrical Characteristics:
Voltage rating:400V AC,DC
Current rating:14A AC,DC
Withstanding voltage:1800V AC minute
Insulationresistance:1000M Ω Min.
Contact resistance:10m Ω Max.
After environmental testing:30m Ω Max.
Temperature range:-40 $^{\circ}$ C ~ +105 $^{\circ}$ C

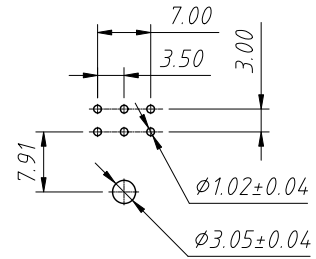
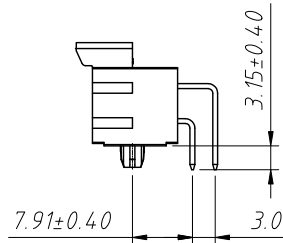
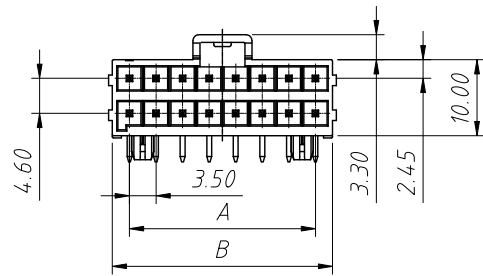

PCB Layout (4-6 Pin)

Order Information:
L-KLS1-XL2-3.50-2 \times XX-R1-B

L: RoHS
Wire To Board
Connector
Pitch:3.50mm
2-Double layer
XX-No.of 04~24 pins
Type:H-Housing T-Terminal
S1 / S2-Straight male pin
R1 / R2-Right angle male pin
Color:
A-KEY A,Black B-KEY B,Natural

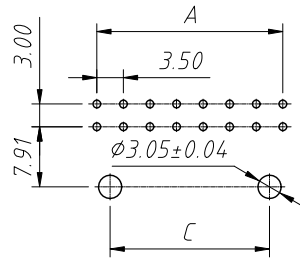
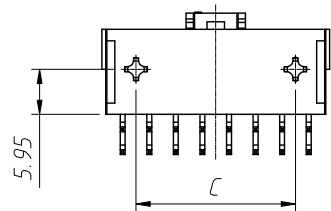

PCB Layout (8-16 Pin)

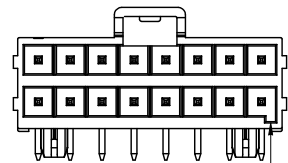

B KEY

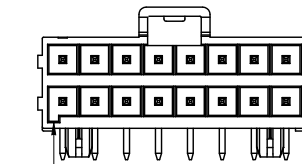

A KEY

Pin	Dimensions(mm)		
	A	B	C
2 \times 02	3.50	8.00	---
2 \times 03	7.00	11.50	---
2 \times 04	10.50	15.00	7.00
2 \times 05	14.00	18.50	10.50
2 \times 06	17.50	22.00	14.00
2 \times 07	21.00	25.50	17.50
2 \times 08	24.50	29.00	21.00
2 \times 12	38.50	43.00	34.00

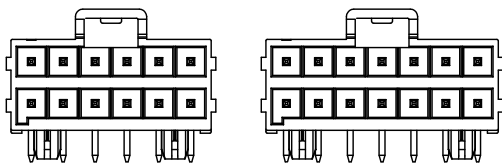
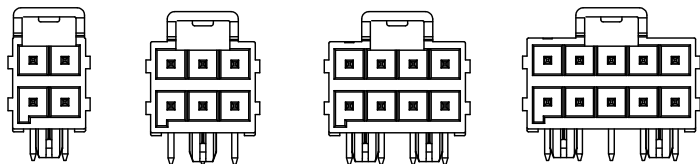

ANGLE TOLERANCE	PROJECTION	Description:	3.50mm Pitch Ultra-Fit 172256 172258 Wire To Board Connector
$\pm 3^{\circ}$			
GENERAL TOLERANCE	UNITS	mm	KLS P/N: L-KLS1-XL2-3.50-2 \times XX-R1-B
x.x ± 0.30	SHEET SIZE	A4	NingBo KLS ELECTRONIC CO.,L TD.
x.xx ± 0.20	Draw:	Daniel	
x.xxx ± 0.10	Check:	Daniel	

