

1 RoHS Compliance

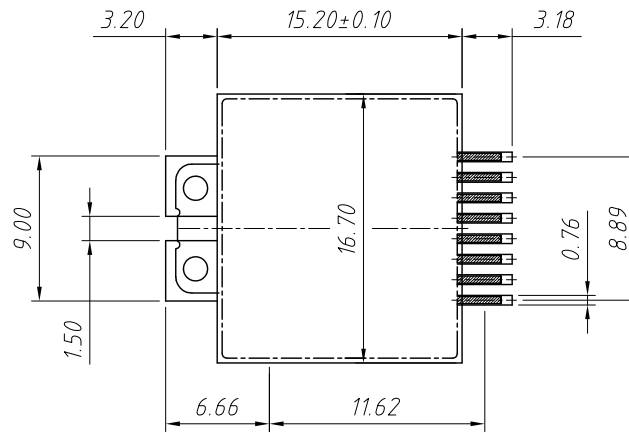
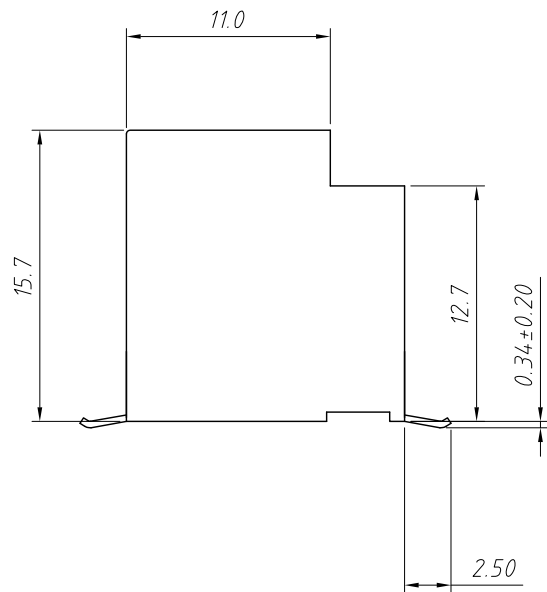
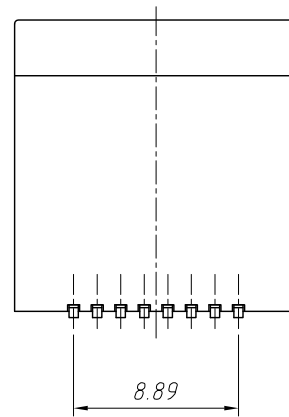
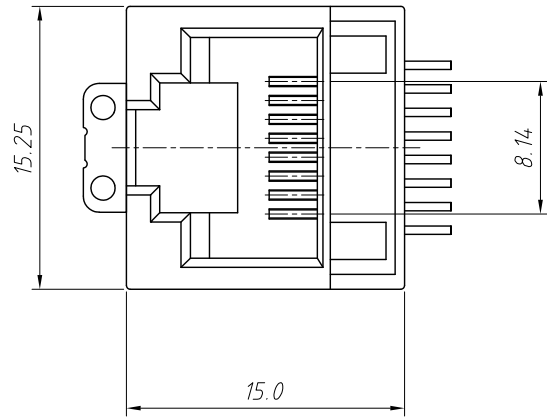

PCB Layout/Top View

Electrical:

- 1.Voltage Rating:125VAC
- 2.Current Rating:1.5A
- 3.Contact Resistance:40mΩ Max.
- 4.Insulation Resistance:1000MΩ Min.@500VDC
- 5.Withstanding Resistance:1000VAC RMS.60Hz 1minute

Materials:

- 1.Housing:High Temp.Thermoplastic Flammability,UL 94 V-0
- 2.Contact:Phosphor Bronze
- 3.Plating:Contact Area:Selective Gold Plating
Tails Plating Tin Over NICKEL

Mechanical:

- 1.Durability:750 cycles Min.

Environmental:

- 1.Storage: -40°C ~ +85°C
- 2.Operation:-20°C ~ +75°C

Order Information:

L-KLS12-SMT28-8P8C-N-XX-P

- L: RoHS
- SMT series
- Point No:8P8C
- Shield:N-Without Shield
- Plating:
- 01: 1u" Gold 02: 3u" Gold
- 03: 6u" Gold 04: 15u" Gold
- 05: 30u" Gold
- Packing:R-Reel P-Blister Tray

ANGLE TOLERANCE	PROJECTION	Description:	RJ45-8P8C SMD Jack Vertical, Without Shell
±3°			
GENERAL TOLERANCE	UNITS	mm	KLS P/N: L-KLS12-SMT28-8P8C-N-XX-P
x.x ±0.30	SHEET SIZE	A4	NingBo KLS ELECTRONIC CO.,L TD.
x.xx ±0.20	Draw:Jenny	Daniel	
x.xxx ±0.10	Check:Daniel	Daniel	
		2021-08-01	
		2021-08-01	