

1  
RoHS Compliance

2

3

4

5

6

7

8

A

B

C

D

E

F

G

H

A

B

C

D

E

F

G

H

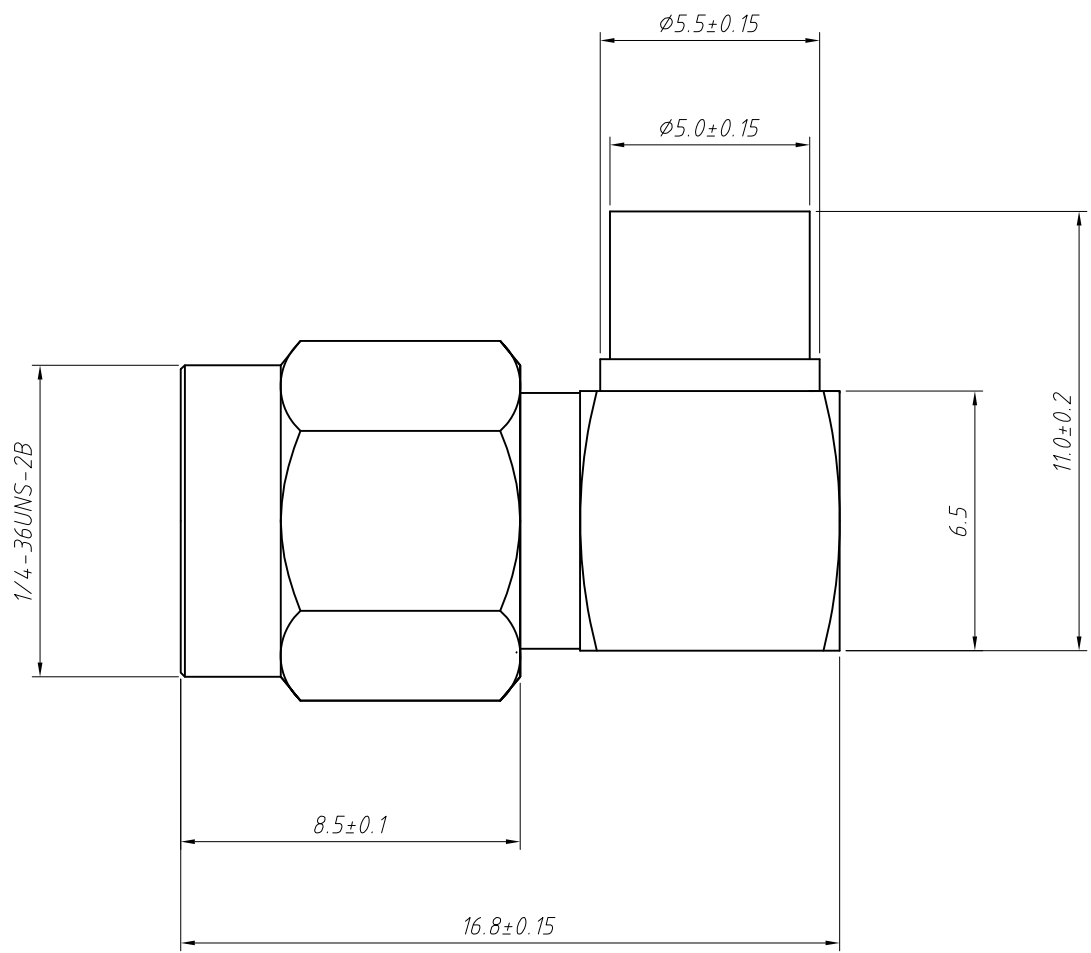

*Material:*

*Connector body: Brass*

*The outer shell of hexagon and welding wire is plated with gold, with the surface thickness of 0.03-0.05 μm; the inner conductor is plated with the surface thickness of 0.05-0.1 μm, with the salt spray for 48 hours*

*Electrical Specifications:*

*Impedance: 50Ω*

*Durability: 500 Cycles Min.*

*Order Information*

L - KLS1 - SMA254

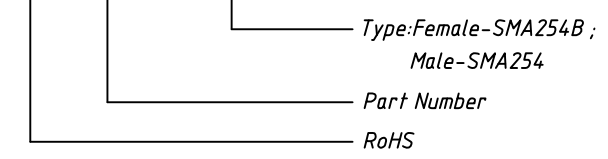

|                   |            |              |   |                                 |
|-------------------|------------|--------------|---|---------------------------------|
| ANGLE TOLERANCE   | PROJECTION | Description: | SMA Cable Connector Right Angle<br>(Plug, Male, 50Ω) RG-402 |                                 |
| ±3°               |            |              |   |                                 |
| GENERAL TOLERANCE | UNITS      | mm           | KLS P/N:  | L-KLS1-SMA254 & L-KLS1-SMA254B  |
| x.x ±0.30         | SHEET SIZE | A4           |   |                                 |
| x.xx ±0.20        | Draw:      | Daniel       | 2018-07-10  | NingBo KLS ELECTRONIC CO.,L TD. |
| x.xxx ±0.10       | Check:     | Daniel       | 2018-07-10  |                                 |