

Material:  
Housing: LCP, UL 94 V-0  
Contact: Copper Alloy.

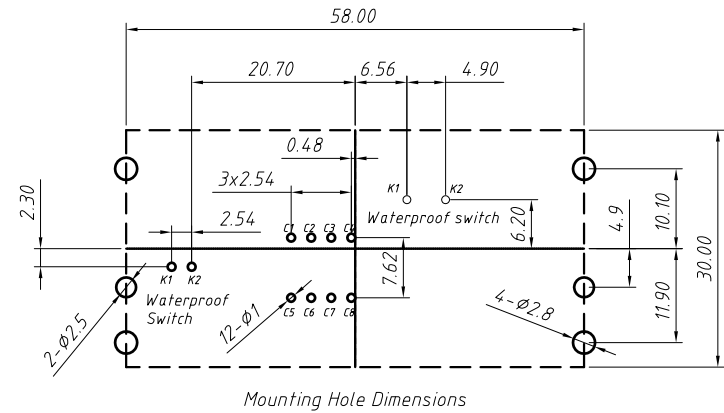
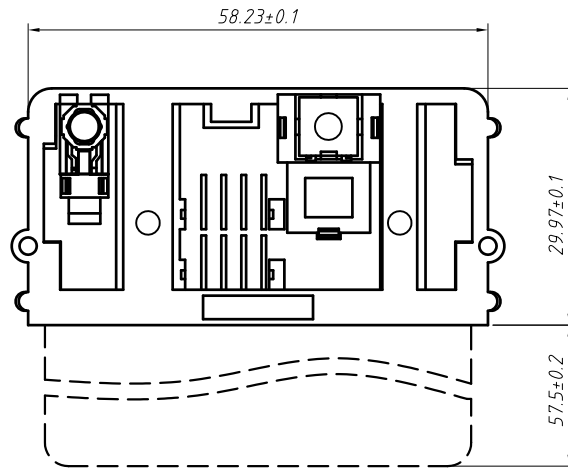
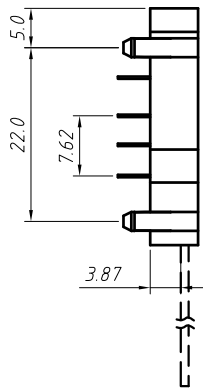

Electrical:  
Current Rating: 2 A  
Contact Resistance: 20mΩ max.  
Insulation Resistance: 1000 MΩ min.  
Dielectric Withstanding Voltage: AC 500V(r.m.s)/60s.  
Durability: 100000 cycles min.  
Operating Temperature: -55°C ~ +125°C

GENERAL TOLERANCE		ANGLE TOLERANCE		PROJECTION		Description:
X	±0.15	X	±5°	UNITS	mm	Smart Card Connector
.X	±0.03	.X	±3°	SHEET SIZE	A4	
.XX	±0.05	.XX	±2°		KLS P/N:	L-KLS1-ISC-F010A-MF
Draw by:	Jenny	Date:	2018-11-01	NingBo KLS ELECTRONIC CO.,LTD.		
Check by:		Date:				
SCALE		SHEET	1 OF 1			