

1 RoHS Compliance

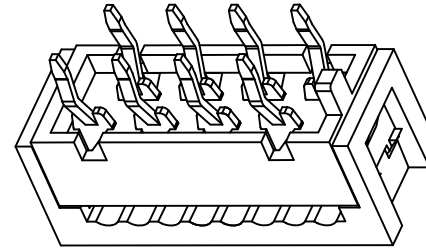
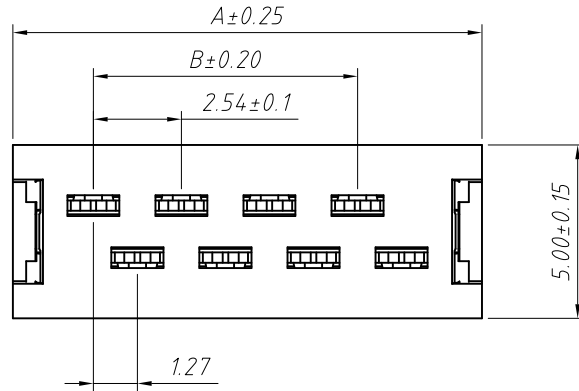

Material:
 Housing:PBT Glass Fiber, UL94V-0
 Contacts:Phosphor Bronze
 Plating:Sn over Ni

Electrical Characteristics:
 Current Rating: 1.0 AMP
 Contact Resistance: 20m Ohm max.
 Insulator Resistance: 1000M Ohm min.
 Withstand voltage:500V AC
 Operating Temperature: -40°C~+105°C

Poles	DIM.A	DIM.B	Qty/Tube
04	8.45	2.54	68
06	10.99	5.08	52
08	13.53	7.62	42
10	16.07	10.16	36
12	18.61	12.70	31
14	21.15	15.24	27
16	23.69	17.78	24
18	26.23	20.32	22
20	28.77	22.86	20
22	31.31	25.40	18
24	33.85	27.94	17
26	36.39	30.48	16

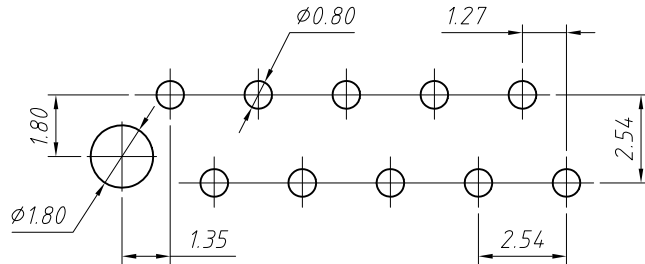
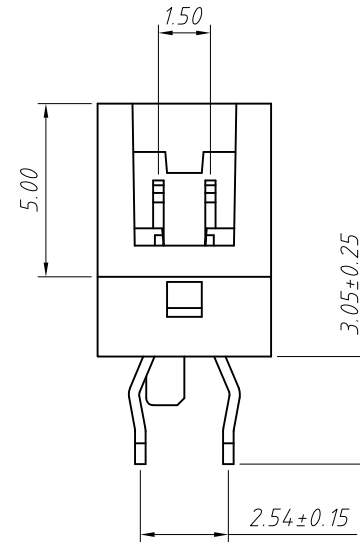
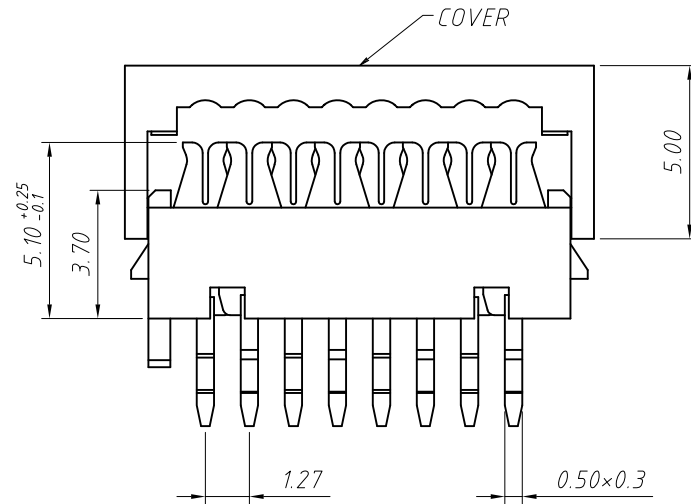

Recommended P.C.B Layout

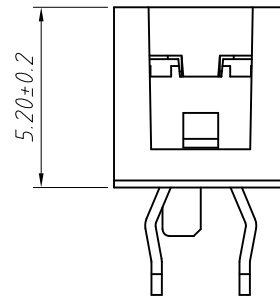

Order Information:
 L-KLS1-204A-XX-R-□
 L: RoHS
 Pitch:2.54mm
 XX-No.of 04~26pin
 Color:R-Red B-Black
 Material:NONE=PBT E=PA46

ANGLE TOLERANCE	PROJECTION	Description:
±3°		Micro Match Dip Plug Connector
GENERAL TOLERANCE	UNITS	mm
x.x ±0.30	SHEET SIZE	A4
x.xx ±0.20	Draw:	Daniel 2018-07-10
x.xxx ±0.10	Check:	Daniel 2018-07-10



NingBo KLS ELECTRONIC CO.,L.TD.