

1 RoHS Compliance

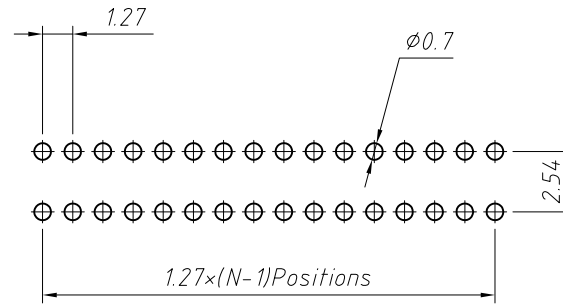
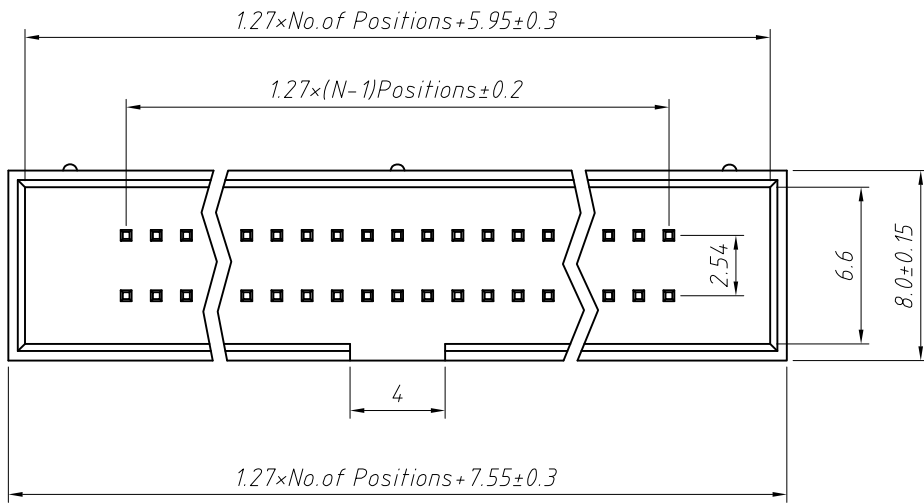

Recommended P.C.B Layout (Top Side)  
(PCB BOARD TOLERANCE±0.05)

**Material:**  
Housing:PA6T or LCP,UL94V-0  
Contact:Brass  
Plating:Gold plated

**Electrical Characteristics:**  
Rated Current: 1.0AMP  
Contact Resistance: 20mΩ Max  
Withstand Voltage: 500V AC/DC  
Insulator Resistance: 1000MΩ Min

**Mechanical**  
Operating Temperature: -40°C ~ +105°C  
Max.Processing Temp:230°C for 30-60 seconds (260°C for 10 seconds)

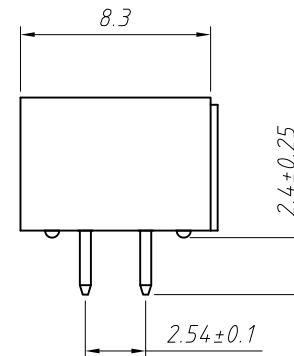
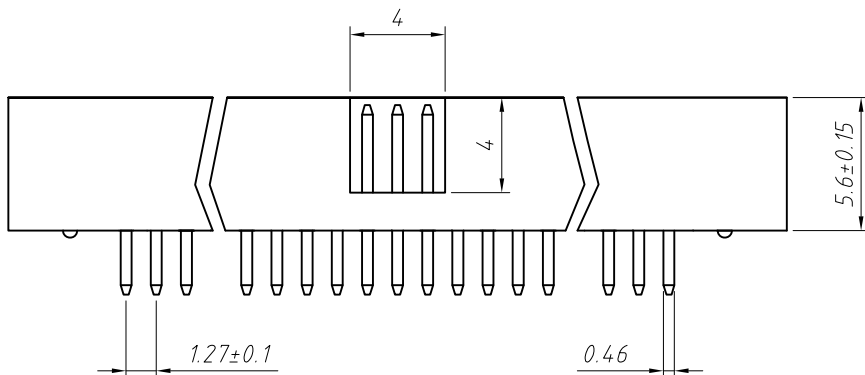

**Order Information:**

L-KLS1-202D-XX-S-B-□

L: RoHS  
Box Header Series  
202D:1.27mm Pitch  
XX-No. of 10 ~ 100 pins  
Type:S-Straight pin  
R-Right Angle Pin T-SMT  
Color:B-Black G-Gray  
Material:NONE=PA6T C=LCP

ANGLE TOLERANCE	PROJECTION	Description:
±3°		1.27x2.54mm Pitch Box Header Connector
GENERAL TOLERANCE	UNITS	mm
x.x ±0.30	SHEET SIZE	A4
x.xx ±0.20	Draw:	Daniel 2018-07-10
x.xxx ±0.10	Check:	Daniel 2018-07-10
		L-KLS1-202D-XX-S-B-□
		NingBo KLS ELECTRONIC CO.,L TD.

RoHS Compliance

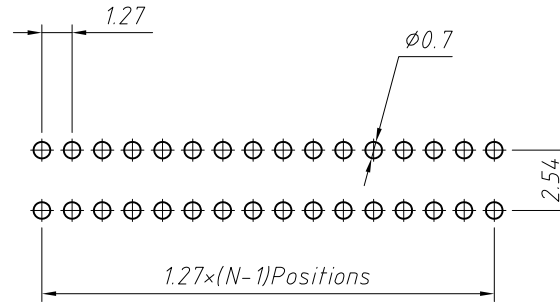
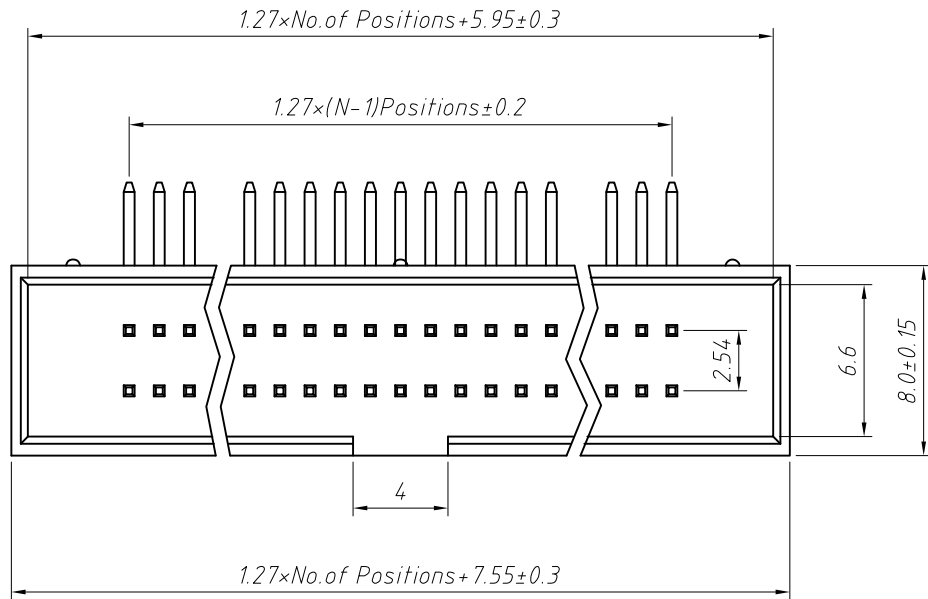

**Material:**  
Housing: PA6T or LCP, UL94V-0  
Contact: Brass  
Plating: Gold plated

**Electrical Characteristics:**  
Rated Current: 1.0AMP  
Contact Resistance: 20m $\Omega$  Max  
Withstand Voltage: 500V AC/DC  
Insulator Resistance: 1000M $\Omega$  Min

**Mechanical**  
Operating Temperature:  $-40^{\circ}\text{C} \sim 105^{\circ}\text{C}$   
Max. Processing Temp:  $230^{\circ}\text{C}$  for 30-60 seconds ( $260^{\circ}\text{C}$  for 10 seconds)

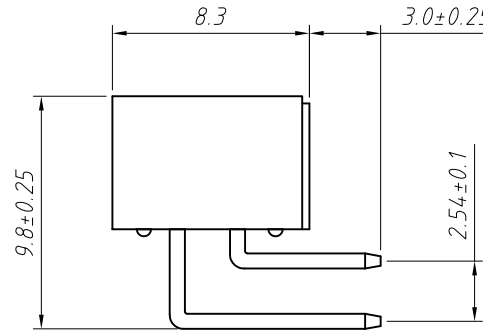
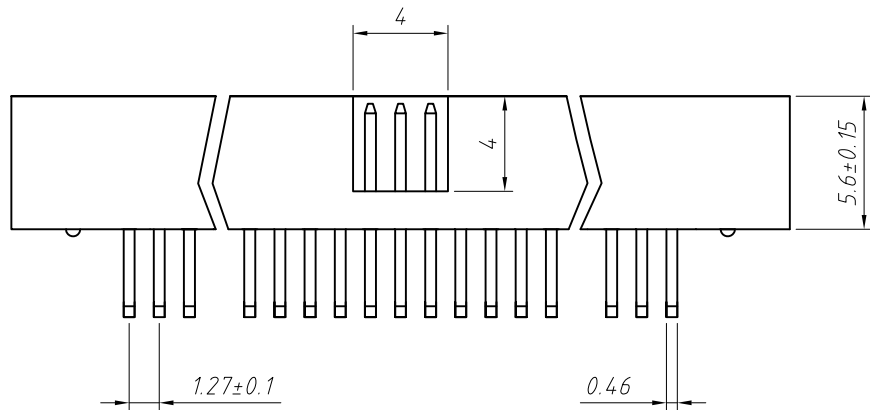

**Order Information:**

L-KLS1-202D-XX-R-B-□

L: RoHS  
Box Header Series  
202D: 1.27mm Pitch  
XX-No. of 10 ~ 100 pins  
Type: S-Straight pin  
R-Right Angle Pin T-SMT  
Color: B-Black G-Gray  
Material: NONE=PA6T C=LCP

ANGLE TOLERANCE	PROJECTION	Description:
$\pm 3^{\circ}$		1.27x2.54mm Pitch Box Header Connector
GENERAL TOLERANCE	UNITS	mm
x.x $\pm 0.30$	SHEET SIZE	A4
x.xx $\pm 0.20$	Draw:	Daniel 2018-07-10
x.xxx $\pm 0.10$	Check:	Daniel 2018-07-10

KLS  
NingBo KLS ELECTRONIC CO.,LTD.

RoHS Compliance

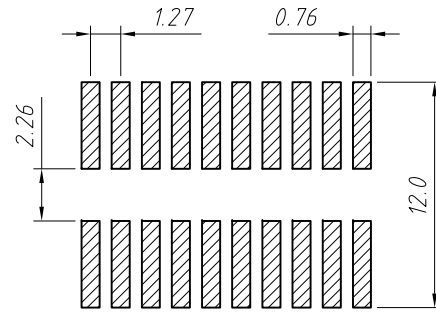
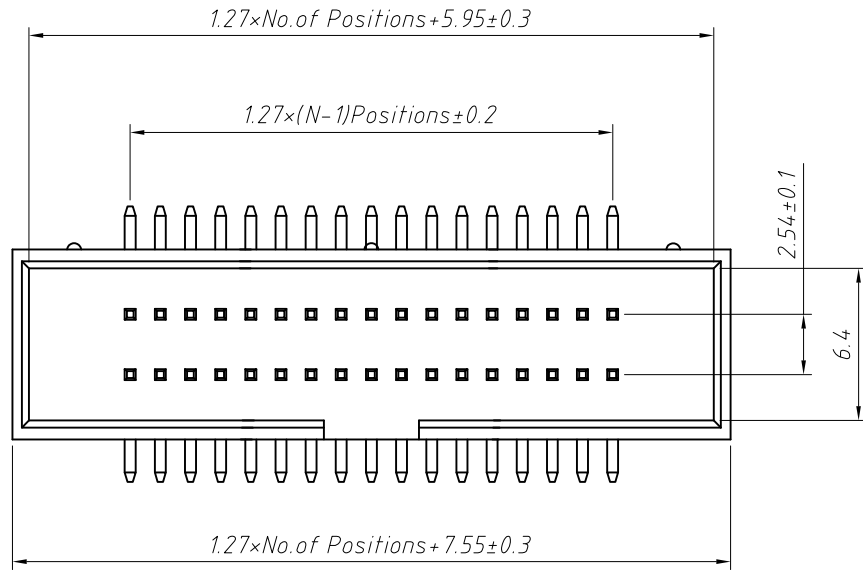

**Material:**  
Housing: PA6T or LCP, UL94V-0  
Contact: Brass  
Plating: Gold plated

**Electrical Characteristics:**  
Rated Current: 1.0AMP  
Contact Resistance:  $20m\Omega$  Max  
Withstand Voltage: 500V AC/DC  
Insulator Resistance:  $1000M\Omega$  Min

**Mechanical**  
Operating Temperature:  $-40^{\circ}C \sim +105^{\circ}C$   
Max. Processing Temp:  $230^{\circ}C$  for 30-60 seconds ( $260^{\circ}C$  for 10 seconds)

Recommended P.C.B Layout (Top Side)  
(PCB BOARD TOLERANCE  $\pm 0.05$ )

Order Information:

L-KLS1-202D-XX-T-B-□-T

L: RoHS  
Box Header Series  
202D: 1.27mm Pitch  
XX-No. of 10 ~ 100 pins  
Type: S-Straight pin  
R-Right Angle Pin T-SMT  
Color: B-Black G-Gray  
Material: NONE=PA6T C=LCP  
Packing:  
T=Tube P=Tube+Cap R=Reel+Cap

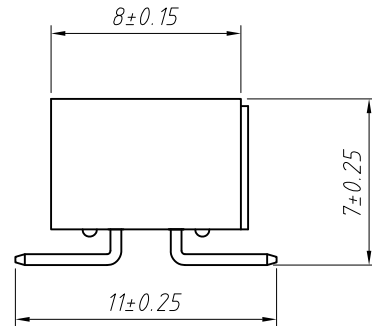
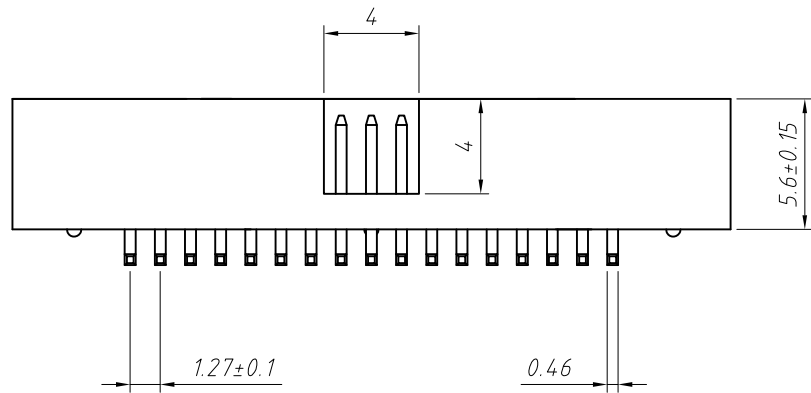

ANGLE TOLERANCE	PROJECTION	Description:		
$\pm 3^{\circ}$		1.27x2.54mm Pitch Box Header Connector		
GENERAL TOLERANCE	UNITS	mm	KLS P/N:	L-KLS1-202D-XX-T-B-□-T
x.x $\pm 0.30$	SHEET SIZE	A4		
x.xx $\pm 0.20$	Draw:	Daniel	2018-07-10	NingBo KLS ELECTRONIC CO.,LTD.
x.xxx $\pm 0.10$	Check:	Daniel	2018-07-10	