

PCB LAYOUT TOP VIEW

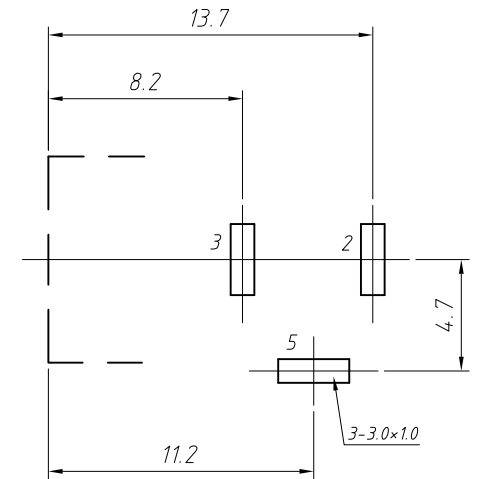

PIN	φ2.0	φ2.5
APPD		

SCHMATIC

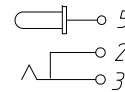

SPECIFICATION

Rated Load:DC 30V 1.0A

Contact resistance:30mΩ, max

Insulation resistance:100MΩ, min

Withstand Voltage:AC500V

Actuating Force:3-20N

Life:5000 cycles

Operating Temperature:-30°C-70°C

NO.	Description	QTY	Material	Plating
1	Housing	1	ABS	---
2	Curve Piece	1	H62 Brass	Cu-Sn-Plating
3	Spring	1	65Mn Steel	Cu-Sn-Plating
4	PIN	1	H59 Brass	Ni-Plating
5	Flat PIECE	1	Brass	Cu-Sn-Plating
6	Cover	1	ABS	---

GENERAL TOLERANCE	PROJECTION		Description:
.X ±0.50	UNITS	mm	DC POWER Jack DIP
.X ±0.25	SCALE	1:1	
.XX ±0.10	Draw by:	Jenny	
ANGLE TOLERANCE	Check by:		KLS P/N: L-KLS1-DC-031
.X ±5°	Date	2019-03-01	NingBo KLS ELECTRONIC CO.,L TD.
.X ±3°	SHEET	1 OF 1	
.XX ±2°			