

SPECIFICATION
 Rated Load:DC 30V 0.5A
 Contact resistance:30mΩ, max
 Insulation resistance:100MΩ, min
 Withstand Voltage:AC500V
 Actuating Force:3-20N
 Life:5000 cycles
 Operating Temperature:-30°C-70°C

PIN	φ2.0	φ2.5
APPD		

SCHEMATIC

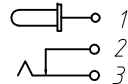

NO.	Description	QTY	Material	Plating
1	1# Curve Piece	1	Brass	Sn-Plating
2	2# Curve Piece	1	Brass	Sn-Plating
3	Spring	1	Bronze	Sn-Plating
4	PIN	1	Brass	Ni-Plating
5	Axis Support	1	Brass	Ni-Plating
6	Housing	1	PBT	---

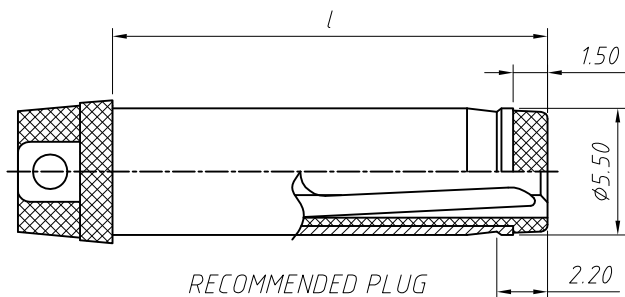

GENERAL TOLERANCE	PROJECTION		Description:
.X ±0.50	UNITS	mm	DC POWER Jack DIP
.X ±0.25	SCALE	1:1	
.XX ±0.10	Draw by:	Jenny	
ANGLE TOLERANCE	Check by:		KLS P/N: L-KLS1-DC-025D
.X ±5°	Date	2019-03-01	NingBo KLS ELECTRONIC CO.,L TD.
.X ±3°	SHEET	1 OF 1	
.XX ±2°			