

Material
 Housing:LCP ,UL 94V-0
 Actuator:LCP ,UL 94V-0
 Contacts:Copper Alloy, Tin Over Nickel
 PEG:Copper Alloy, Tin Over Nickel

Electrical
 Voltage rating: 50 V
 Current Rating: 0.3 A

Mechanical
 Temp. Range: $-25^{\circ}\text{C} \sim +85^{\circ}\text{C}$

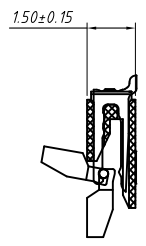
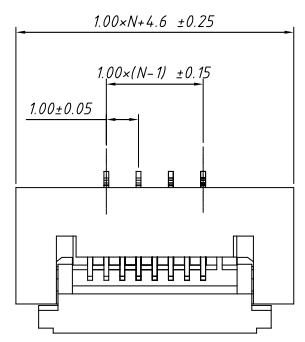

Section:A-A

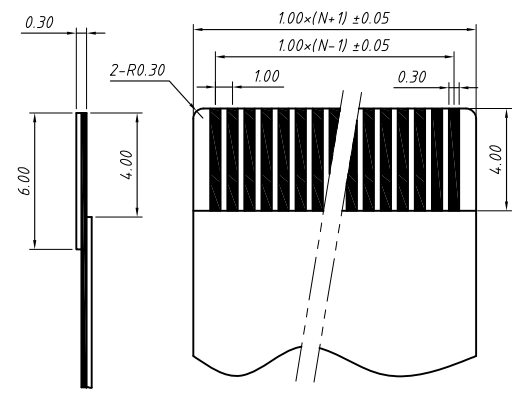

Proper Cable

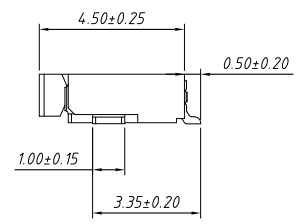
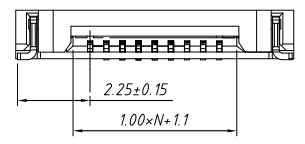

Order Information

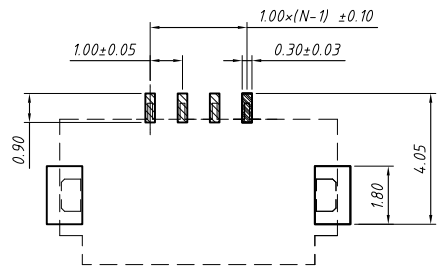
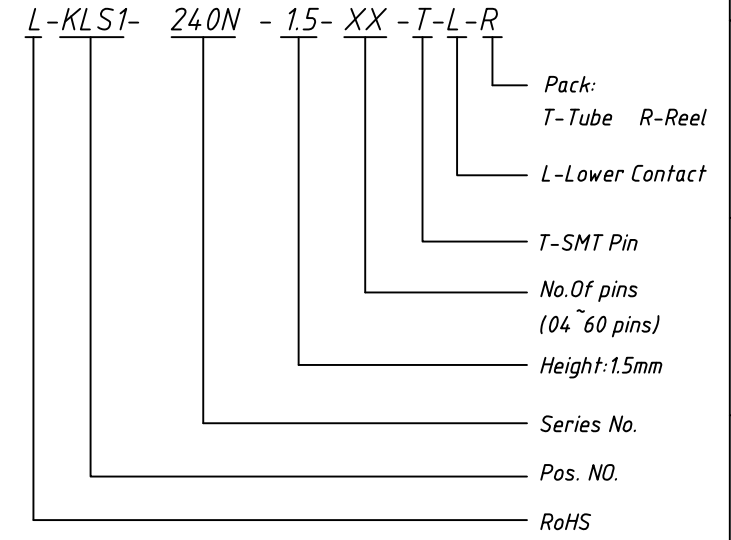

GENERAL TOLERANCE		ANGLE TOLERANCE		PROJECTION		Description:	
X.	±0.15	X.	±5°	UNITS	mm	CONN FFC 1.00mm,SMD, Horizontal,Lower Contact , with ZIF L-KLS1-240N-1.5-XX-T-L-R	
.X	±0.03	.X	±3°	SHEET SIZE	A4		
.XX	±0.05	.XX	±2°	KLS P/N:			

Draw by: Date	2018-03-10		
Check by: Date	2018-03-10		
SCALE	SHEET	OF	

NingBo KLS ELECTRONIC CO.,L TD.