

Power Chokes Inductors



L-KLS18-CH1216U-103K-02 Inductors

ELECTRIC CHARACTERISTICS:

INDUCTANCE: 10MH±10%
TEST FREQ: 1KHZ/0.25V
TURNS: 450.5T (REF)
IDC:500mA Max
Temperature range: -20 ° C to +100 ° C

MATERIALS:

CORE: DR2W12*16
PIN: CP08*15
WIRE: φ 0.20m/m 2UEW KG/KPC
PACKING:Polybag

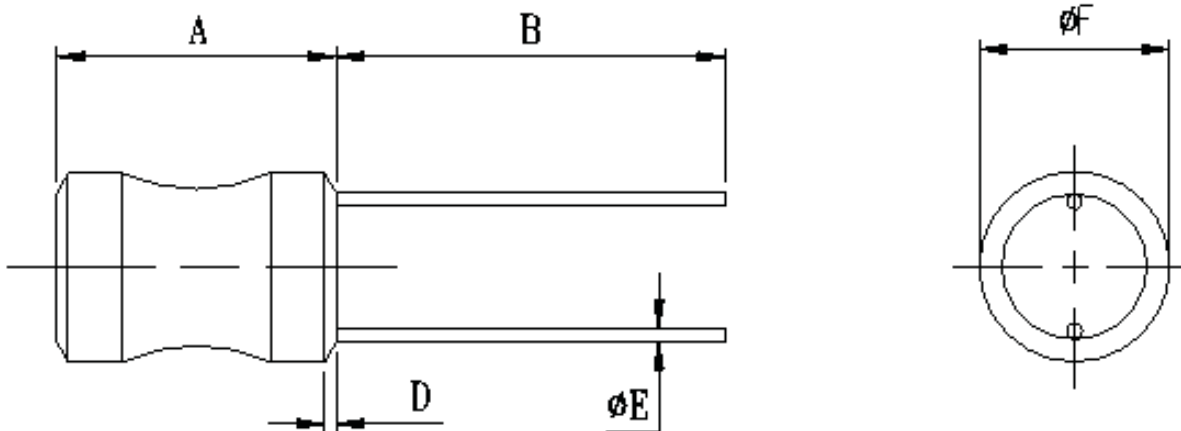

A: 19.5 MAX	B: 15.0±2.0	D: 2.0MAX
E: 0.8±0.05	F: 13.5 MAX	

ORDER INFORMATION

Product No.: KLS18-CH1216U-103K-02

Pos. No. _____

Wire: φ 0.20m/m

Size:CH1216U _____

Inductance: 103 Example: "103"for 1mH
Tolerance:"M":±20%, "K":±10%, "J":±5%