

## PLC housing

KLS24-JG3-10 115\*90\*72mm PLC housing, gray

### Product Description:

- \*Product Material: ABS
- \*Widely used in various PLC module circuit, a controller unit, with electrical module, PLC
- \*Product Standard accessories: cap, base, retainer, four screws
- \*Product side terminal Optional:
  - (1) 5.0 spacing terminal can be equipped with 13 (14 can be, but is tight)
  - (2) can be equipped with terminal pitch of 7.62 9
- \*Two installation methods:
  - (1) screws
  - (2) fast and simple rail mounting
- \*Fully insulated protection
- \*Good heat dissipation
- \*Product color and material batch can be customized
- \*Product cover may require modification

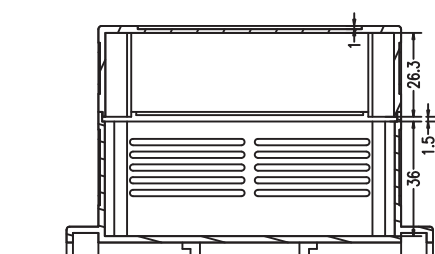
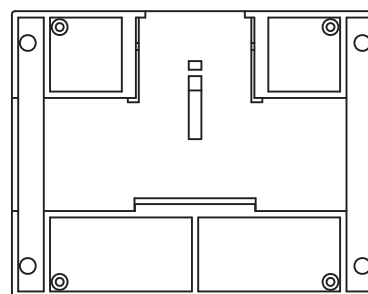
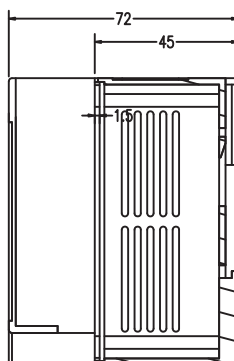
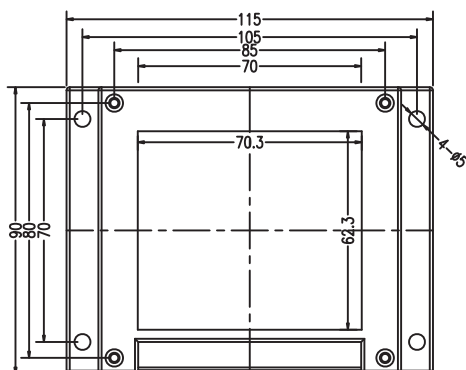
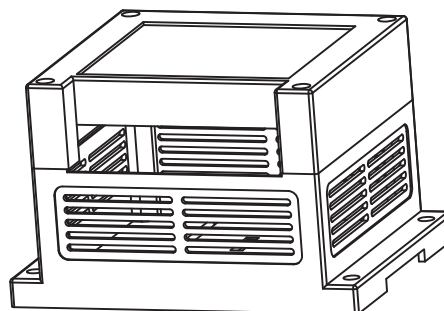

剖面 A-A

剖面 B-B

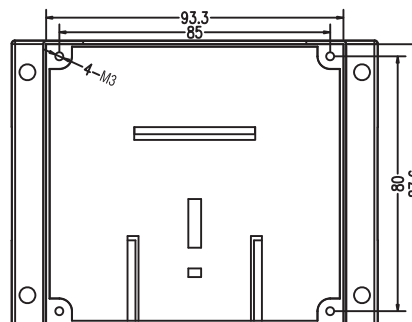

## ORDER INFORMATION

Product NO.: KLS24-JG3-10

Pos. NO.

No.