

KLS23-TS-24BYJ48 24mm gearbox stepping motor

- Small size dc gear motor with low speed and big torque
- 24mm gear motor provide 0.05Nm torque and more reliable
- Suitable to small diameter, low noise and big torque application
- Reduction Ratio: 16、25、64

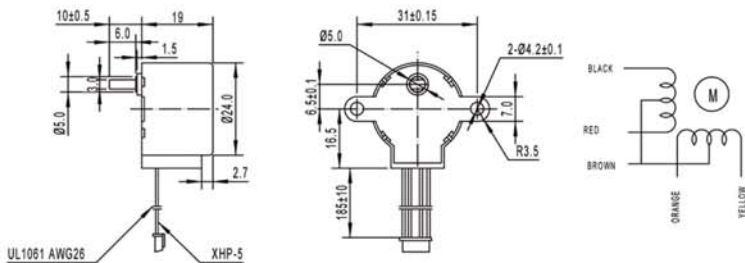

Gear Motor Dimensions (mm)



Stepping Gear motor Technical Data

Motor model No.	Rated voltage	No.of Phase	Step Angle	Gear Ratio	Resistance	Holding Torque	current	Pull in Rate	
	VDC				Ω	g.cm	mA	pps	
TS-24BYJ48-16	12	2	5.625°	1/16	50	500	400	800pps	
TS-24BYJ48-25	5	4	5.625°	1/25	20	500	250	800pps	
TS-24BYJ48-64	12	4	5.625°	1/60	120	1000	100	800pps	