	KLS23-B9080M	Output Power: 40W~450W	Weight: 1200g (Approx.)
	Brushless DC Motor-Typical Application Automobile Parts: Auto Pumps, Electro Carrier, Auto Actuator Home Application: Electric Window, Electric Door, Blender, Shredder, Meat Grinder Medical Apparatus: Medical Bed, Electric Wheel Chair, Surgery Tools, Operating Table, Centrifugal Machine Power Tools: Screwdriver, Drill, Air Compressor Industry Equipment: Power Machine, Transmission gear equipment Personal Life Product: Massager, Sport Apparatus		

Model	Voltage(V)		No Load		Rated Load			Stall		
	Operating Range	Rated	Speed (rpm)	Current (A)	Torque (mNm)	Speed (rpm)	Current (A)	Output P. (W)	Torque (mNm)	Current (A)
B9080M-S01	8-28	12	2050	0.91	250	1750	5.22	45.7	1670	29.7
B9080M-S02	8-28	24	3380	0.74	500	2820	7.75	147.5	3002	42.8
B9080M-S03	30-60	36	4520	0.65	800	3500	10.6	292.9	3535	44.8
B9080M-S04	30-60	48	4950	0.54	1000	3900	10.7	408	4731	48.8

Characteristic: CW & CCW, Signal function available, Locked rotor protection, Stepless speed regulation, Low noise, Low EMI, Long life 10000-50000hrs

Notice: Data in this typical specification sheet are for other certain customer, the specific BLDC motor performance and dimension can be changed by adjusting winding, magnetic field, controller parameter and relevant mechanical factor to meet different customer requirement.

Outline Drawing:

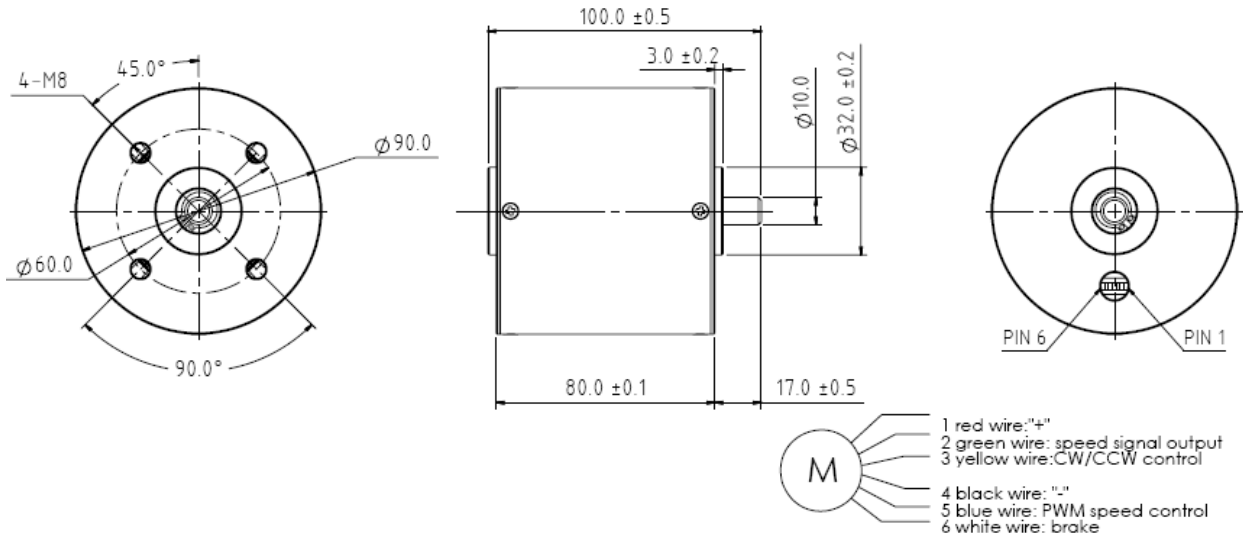

Usable machine screw length 8.0mm max. from motor mounting surface

Unit: Millimeter

Performance Curve:

B9080M-S02

24V

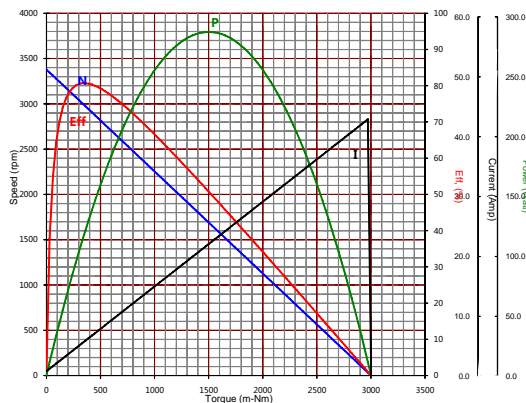

B9080M-S03

36V

