

RoHS Compliance

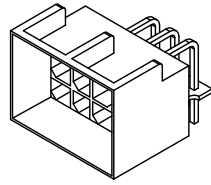

Pin	Dimensions(mm)		
	A	B	C
2x02	3.00	13.00	---
2x03	6.00	16.00	---
2x04	9.00	19.00	4.68
2x05	12.00	22.00	7.68
2x06	15.00	25.00	10.68
2x07	18.00	28.00	13.68
2x08	21.00	31.00	16.68
2x09	24.00	34.00	19.68
2x10	27.00	37.00	22.68
2x11	30.00	40.00	25.68
2x12	33.00	43.00	28.68

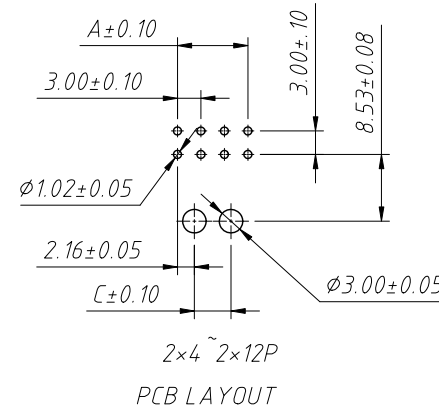
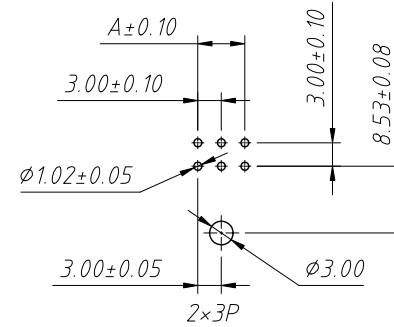
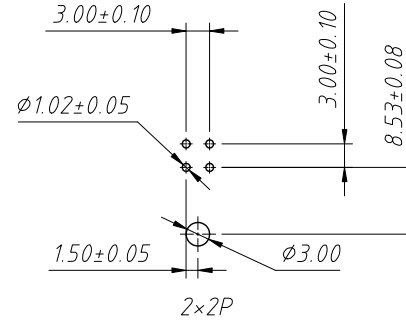
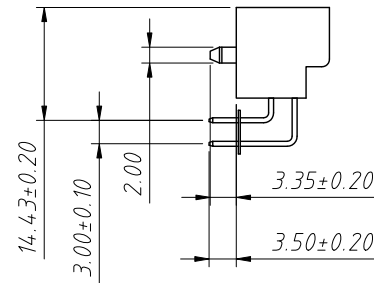
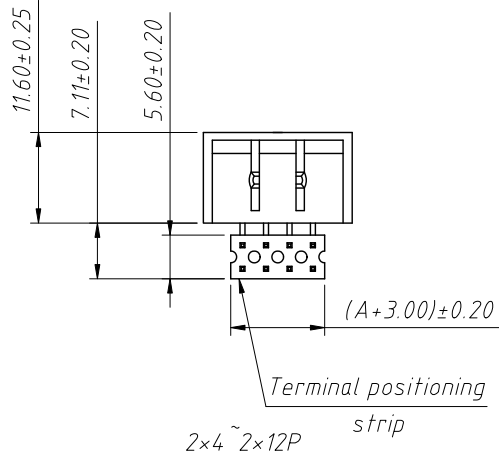
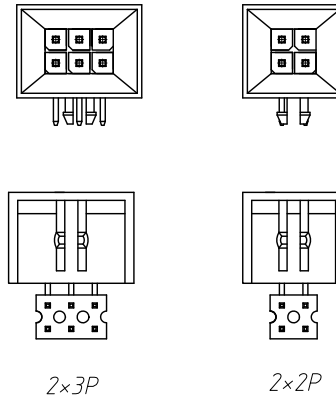
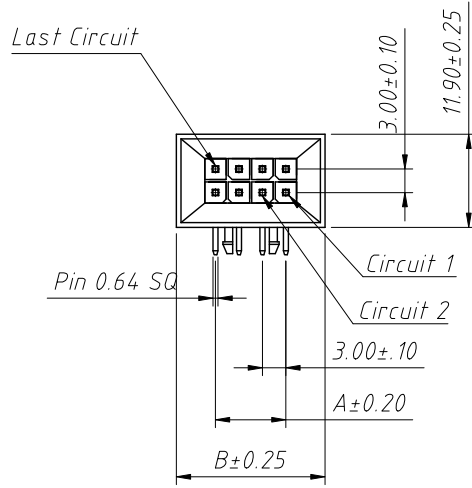

Material:

Housing:LCP,UL 94V-0

Color:Blank-Natural Color

Pin:Brass,Bright Tin Plating

Electrical Characteristics:

Current rating:5.0A AC,DC

Voltage rating:250V AC,DC

Insulation resistance:1000MΩ Min.

Withstanding voltage:1000V AC minute

Contact resistance:10mΩ Max.

After environmental testing:20mΩ Max.

Temperature range:-25°C ~ +85°C

Order Information:

L-KLS1-XM3-3.00-2xXX-R2

L: RoHS

Wire To Board

Connector

Pitch:3.00mm

2-Double layer

XX-No. of 04 ~ 24 pins

Type:

MH/FH-Housing MT/FT-Terminal

S1/S2-Straight male pin

R1/R2-Right angle male pin

ANGLE TOLERANCE	PROJECTION	Description:
±3°		3.0mm Pitch Micro-Fit 44133/44300 Right angle 90° and Female
GENERAL TOLERANCE	UNITS	mm
x.x ±0.30	SHEET SIZE	A4
x.xx ±0.20	Draw:	Daniel 2020-11-11
x.xxx ±0.10	Check:	Daniel 2020-11-11



NingBo KLS ELECTRONIC CO.,LTD.