

RoHS Compliance

REV	SYM	Revision Record	Appr.	Date
V0	KLS01140	New Version Release	Song	2023-12-27

Order Information

L-KLS1-XM4-3.00-2X06D-S

- RoHS
- Wire To Board
- Pitch:3.00mm
- 2-Double Layer
- XX-No.of Pins
- S-Straight Male Pin

NOTE:

- 1.Material:
Insulator:PA9T,UL94V-0,Black.
PWR & GND Pin: C1100,
Sense Pin:C2680
Board Lock:SUS201
- 2.Finish:
Contact: 80u"Min Matte Tin Plated Overall,
30u" Min Nickelunder Plated

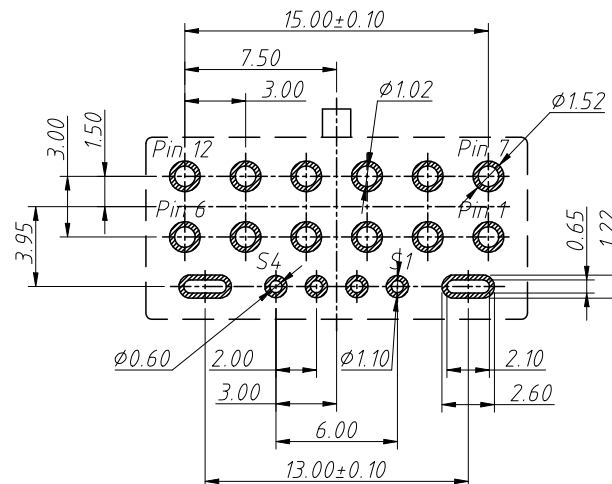
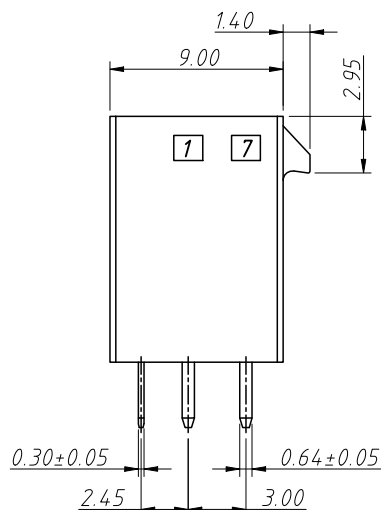
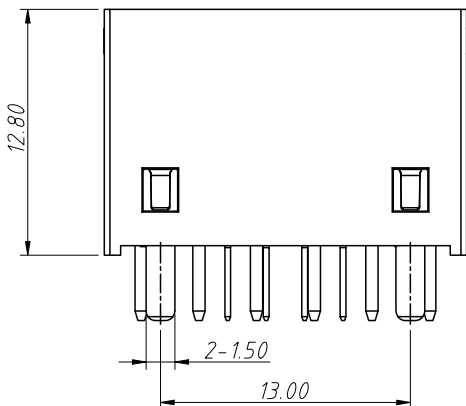
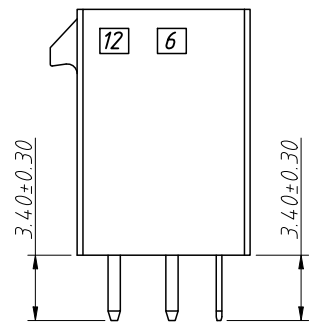
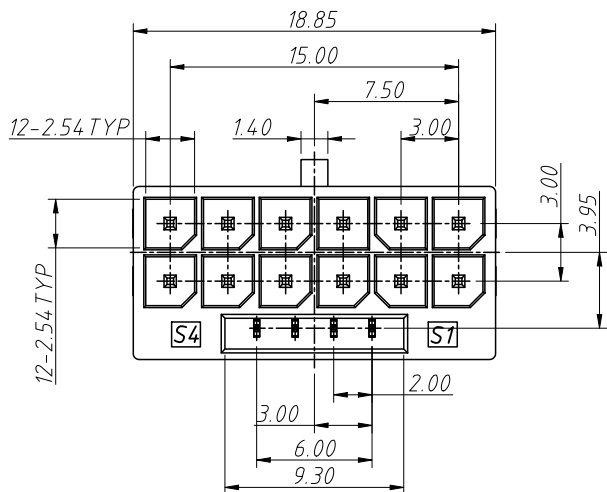

Recommend P.C.B Layout
Tolerance:±0.05(Top View)

3.Electrical Characteristics:

- Current Rating:9.2A Per Pin(PWR & GND PIN)
- Dielectric Withstanding Voltage:1500 VAC 1Minute
- Insulation Resistance:1000MΩ Min.AT 500V/DC
- Contact Resistance:10mΩ Max
- Temperature Range:-4.0°C ~ +105°C

Pin Signal	PIN NO.
PWR Pin	1-6
GND Pin	7-12
S1	CARD_PWR_STAB
S2	CARD_CBL_PRES
S3	SENSE0
S4	DO NOT USE

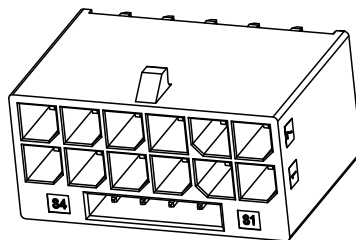
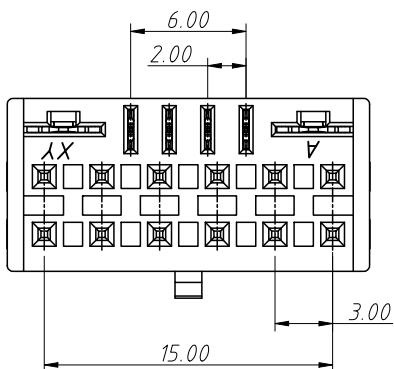

ANGLE TOLERANCE	PROJECTION	Description:
±3°		Pitch 3.00mm 12+4P PCIe Housing
GENERAL TOLERANCE	UNITS	mm
x.x ±0.25	SHEET SIZE	A4
x.xx ±0.20	Draw:	Song
x.xxx ±0.05	Check:	Daniel
		KLS P/N: L-KLS1-XM4-3.00-2X06D-S



NingBo KLS ELECTRONIC CO.,L TD.